

POWER-STRUT® Part No. Std Wt./ List Price
& Length Fin. Qty 100 per 100 pcs

PA 158

Slotted Angle
1 5/8" x 1 5/8" x 14 ga.

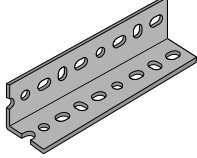

per 100 ft.					
PA 158 10	GR	100'	66		\$317.13
PA 158 10	PG	100'	66		\$317.13
PA 158 12	GR	120'	66		\$317.13
PA 158 12	PG	120'	66		\$317.13

PA 238

Slotted Angle
1 5/8" x 2 3/8" x 14 ga.

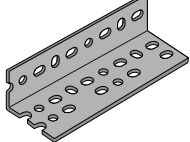

per 100 ft.					
PA 238 10	GR	100'	80		\$361.01
PA 238 10	PG	100'	80		\$361.01
PA 238 12	GR	120'	80		\$361.01
PA 238 12	PG	120'	80		\$361.01

PA 318

Slotted Angle
1 5/8" x 3 1/8" x 12 ga.

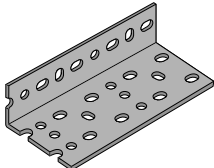

per 100 ft.					
PA 318 10	GR	100'	130		\$501.95
PA 318 10	PG	100'	130		\$501.95
PA 318 12	GR	120'	130		\$501.95
PA 318 12	PG	120'	130		\$501.95

PA 1 GP

Gusset Plate

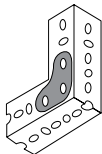

PA 1GP	EG	25	9		\$199.99
--------	----	----	---	--	----------

PA 1 HDC

Portable Cutter

Note: Price shown is for each.

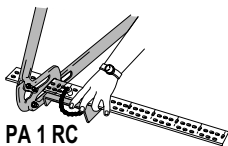

price each					
PA 1HDC		1 each	17		\$1394.37

PA 1 RC

Rigid Caster



PA 1RC	EG	1 Pair	110		\$7932.26
--------	----	--------	-----	--	-----------

PA 1 RP

Slotted Reinforcement Strap 1 5/8" x 14 ga.

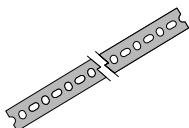

PA 1RP 10	PG	100'	35		\$158.57
-----------	----	------	----	--	----------

POWER-STRUT® Part No. Std Wt./ List Price
& Length Fin. Qty 100 per 100 pcs

PA 1 SC

Swivel Caster

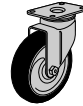

PA 1SC	EG	1 Pair	170		\$10001.54
--------	----	--------	-----	--	------------

PA 1 SNB

3/8" X 3/4" Hex Head Bolt 3/8" Serrated Hex Nut



PA 1SNB	EG	75	7		\$57.03
---------	----	----	---	--	---------

PS LS

Clamping Nut With Long Spring

Use With PS 100 and PS 150 Channel

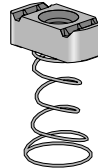

PS LS 1/4	EG	50	7.5		\$227.95
PS LS 3/8	EG	50	10.2		\$230.14
PS LS 1/2	EG	50	12		\$243.85
PS LS 5/8	EG	50	16		\$407.17
PS LS 3/4	EG	50	14.1		\$459.05

PS NS

Clamping Nut With Out Spring

Use With All 1 5/8" Wide Channel



PS NS 10-24	EG	100	7		\$156.81
PS NS 1/4	EG	100	7		\$138.35
PS NS 5/16	EG	100	6.4		\$154.38
PS NS 3/8	EG	100	9.3		\$128.02
PS NS 1/2	EG	100	11.4		\$141.88
PS NS 5/8	EG	100	15		\$267.47
PS NS 3/4	EG	100	13		\$311.19
PS NS 7/8	EG	100	14		\$317.13
PS NS S 1/2	EG	100	6.9		\$165.36
PS NS S 5/8	EG	100	9.7		\$321.23
PS NS S 3/4	EG	100	8		\$358.83

PS RS

Clamping Nut With Regular Spring

Use With PS 200, PS 210 and PS 300

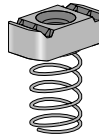

PS RS 8-32	EG	100	7.2		\$217.91
PS RS 10-24	EG	100	7.2		\$195.37
PS RS 10-32	EG	100	7.2		\$206.51
PS RS 1/4	EG	100	7		\$141.47
PS RS 5/16	EG	100	7		\$183.00
PS RS 3/8	EG	100	10		\$151.76
PS RS 1/2	EG	100	12		\$168.49
PS RS 5/8	EG	100	16		\$297.58
PS RS 3/4	EG	100	14		\$341.55
PS RS 7/8	EG	100	14		\$408.53