

# Surge Protection

## Power Service Entrance Surge Protection

### FirstSurge™ - Power, Plus, or Pro

- 4th Listed, Type 2, Surge Protective Device (SPD)
  - Surge Current Capacities:
    - 60,000 A, FirstSurge Power (FS060)
    - 100,000 A, FirstSurge Plus (FS100)
    - 140,000 A, FirstSurge Pro (FS140)
  - 3 Stage Commercial Grade Notification:
    - Protection Status LEDs
    - Audible Alarm
    - Flashing Red Service LED
  - Ground Reference Monitoring (GRM)
  - 10 year product & connected equipment warranty\*
- \* See [www.usa.siemens.com/surge](http://www.usa.siemens.com/surge) for warranty terms and conditions.

Surge Type	Catalog Number
FirstSurge Power	<b>FS060</b>
FirstSurge Plus	<b>FS100</b>
FirstSurge Pro	<b>FS140</b>

AC Surge Protection	
UL and CSA Listings	1449 4th Edition & CSA 22.2 No. 269.2
Surge Spike Capacity	60kA, 100kA, or 140kA
Line Voltage	120/240 1 Phase 50/60 Hz
UL 1449 4th Edition VPR	L-N, L-G, N-G: 600 V; L-L: 900V
Rated Voltage (MCOV)	L-N, L-G, and N-G: 150V; L-L: 300V
Short Circuit Current Rating (SCCR)	100kA
Inominal (I <sub>n</sub> ) Rating	20kA
Response Time	<1 nanosecond
Enclosure	NEMA 4X Indoor and Outdoor Rated
Product Warranty	10 years

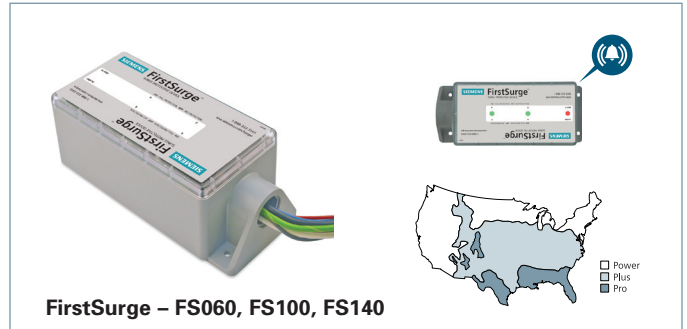

**FirstSurge – FS060, FS100, FS140**

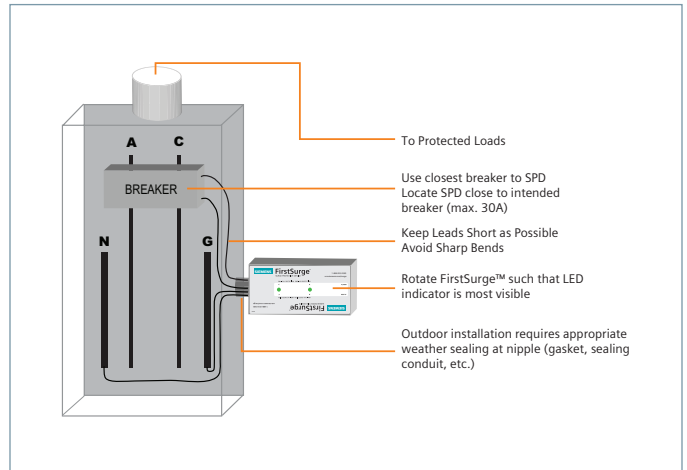

## Type 1 SPD / Surge Arrestor Replacement

### TPS3 03

TPS3 03 is a UL 1449 4th Edition 50 kA Type 1 compact surge protective device that can be used as a replacement secondary surge or lightning arrestors. Having a Type 1 designation allows for flexible electrical system connection location (line or load side) as well as UL 96A compliance (@ 20 kA I<sub>n</sub>).

#### TPS3 03 Key Features

- UL 1449 4th Edition Listed Type 1
- Type 1 Rated SPD
- 50 kA Per Phase Surge Current
- 20 kA I<sub>n</sub> (Most models)
- 200 kA SCCR (Most models)
- UL 96A Lightning Protection Master Labeling compliant (@ 20 kA)
- Every MOV is monitored
- Mounts external to electrical distribution equipment
  - Recommend for Line Side or Load Side Applications
- Standard compact NEMA 4X polycarbonate enclosure
- Modes of Protection: L-N or L-G and L-L
- Standard Monitoring: LED Indicator
- Dimensions: 3.25" x 3.25" x 3.3" (82.6 mm x 82.6 mm x 83.8 mm)
- Weight: 2 lb. (0.9 kg)
- 2 Year Product Warranty

#### Available Options:

- Dry contacts & Audible Alarm (option "D")



#### Ordering Information

Catalog # **TPS3**  **03**

<p><b>Voltage Code</b></p> <p><b>A</b> = 120/240 V, 1Ø, 3W  <b>B</b> = 120/240 V, 3Ø, 4W  <b>C</b> = 120/208 V, 3Ø, 4W  <b>D</b> = 240 V, 3Ø, 3W  <b>E</b> = 277/480 V, 3Ø, 4W  <b>F</b> = 480 V, 3Ø, 3W  <b>G</b> = 600 V, 3Ø, 3W  <b>K</b> = 380/220 V, 3Ø, 4W  <b>L</b> = 600/347 V, 3Ø, 4W</p>	<p><b>Surge Current (kA)</b></p> <p><b>05</b> = 50 kA per phase</p>	<p><b>Options</b></p> <p><b>D</b> = Dry contact &amp; audible alarm</p> <p><b>N</b> = Adds N-G Protection</p>
------------------------------------------------------------------------------------------------------------------------------------------------------------------------------------------------------------------------------------------------------------------------------------------------------------------------------------	---------------------------------------------------------------------	---------------------------------------------------------------------------------------------------------------

Example: **TPS3C0305D0** = Type 1 SPD for a 208/120V application with a surge current capacity of 50 kA per phase, in a standard NEMA 4X enclosure with dry contacts and audible alarm option. When an option is not selected, include a **zero (0)** in the field.

**Available Accessories: Ordered Separately**

**RMSIE** = Remote monitor