

SUPERBAY BI SERIES

14" ALUMINUM
REFLECTOR

Cat. #		Approvals
Job	Type	



APPLICATIONS

- Narrow, medium and wide lighting distributions for applications flexibility.

SPECIFICATIONS

- Anodal[®] finished 14" diameter spun aluminum reflector.
- Field adjustable brackets provide narrow, medium and wide lighting distributions.
- Rugged, two-piece, die cast aluminum ballast housing with corrosion-resistant Lektrocote[®] white finish.
- Unit Pack available, see table below (lamp included in Unit Pack).

LISTINGS

- Up to 55°C ambient, suitable for damp location, minimum 90°C supply conductors.

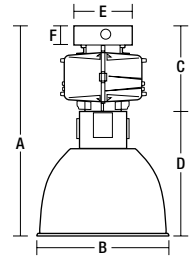

	A	B	C	D	E	F
SLICK-ON[®]	22 ³ / ₁₆ "-24 ⁷ / ₁₆ "	14 ¹ / ₄ "	9 ¹ / ₂ "	9 ⁷ / ₁₆ "	9 ¹ / ₂ "	2"
	564-621 mm	362 mm	241 mm	240 mm	241 mm	51 mm
QUICK-ON[®]	21 ⁵ / ₁₆ "-23 ⁹ / ₁₆ "	14 ¹ / ₄ "	8 ⁵ / ₈ "	9 ⁷ / ₁₆ "	9 ⁷ / ₁₆ "	1 ¹ / ₈ "
	541-598 mm	362 mm	219 mm	240 mm	240 mm	29 mm

ORDERING INFORMATION

ORDERING EXAMPLE: BL-400P8-BI-WH

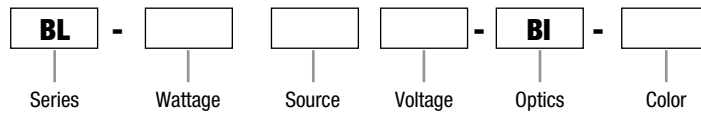

SERIES

BL Superbay Series

WATTAGE

150	150 watt HPS
175	175 watt Pulse Start MH only
200	200 watt Pulse Start MH only
250	250 watt MH, Pulse Start MH or HPS
320	320 watt Pulse Start MH only
350	350 watt Pulse Start MH only
400	400 watt Pulse Start MH or HPS
450	450 watt Pulse Start MH only

SOURCE

S	High Pressure Sodium
P	Pulse Start Metal Halide

VOLTAGE

5	480V
6	Tri-Tap [®] - 120/277/347V
7	600V (isolated secondary only)
8	Quad-Tap [®] - 120/208/240/277V

OPTICS

BI 14" Spun Aluminum Highbay Reflector with upright

COLOR

WH	White (standard)
GR	Gray (optional)

NOTE: Energy Saving Linear Reactor Pulse Start ballast available, consult factory (277V only).
NOTE: Bottom enclosures are required unless lamps designated as "suitable for open use" are used.
NOTE: Options must be added as suffix to Catalog Number. Accessories must be ordered separately.

ACCESSORY

Order separately

BOTTOM ENCLOSURE

BL-LR-14 Bottom Enclosure

BI UNIT PACKS

MATERIAL	MATERIAL DESCRIPTION	WATTAGE	VOLTAGE	LAMP BASE	LAMP INCLUDED
METAL HALIDE PULSE START					
BL320P8BCXUPL	BL-320P8-BC-WH-EX-UPL	320	Quad-Tap	Exclusionary	Lamp Included
BL320P8BCWHUPL	BL-320P8-BC-WH-UPL	320	Quad-Tap	Mogul	Lamp Included
BL400P8BCXUPL	BL-400P8-BC-WH-EX-UPL	400	Quad-Tap	Exclusionary	Lamp Included
BL400P8BCWHUPL	BL-400P8-BC-WH-UPL	400	Quad-Tap	Mogul	Lamp Included
HIGH PRESSURE SODIUM					
BL400S8WHBIUPL	BL-400S8-WH-BI-UPL	400	Quad-Tap	Mogul	Lamp Included

ORDERING INFORMATION

OPTIONS FOR SUPERBAY SERIES

Factory installed — order with fixture by adding suffix.

PLUGS ARE TWIST-LOCK® TYPE AS MANUFACTURED BY HUBBELL WIRING DEVICES.

Suffix	Description
-CFB	Charcoal filter breather
-C4HL	4' Cord, Hook/Loop w/ Quick-On® Hanger - SO cord wired thru hook
-C6HL	6' Cord, Hook/Loop w/ Quick-On® Hanger - SO cord wired thru hook
-C8HL	8' Cord, Hook/Loop w/ Quick-On® Hanger - SO cord wired thru hook
-C10HL	10' Cord, Hook/Loop w/ Quick-On® Hanger - SO cord wired thru hook
-C12HL	12' Cord, Hook/Loop w/ Quick-On® Hanger - SO cord wired thru hook

CORD, HOOK/LOOP & 20A PLUG W/ QUICK-ON® HANGER -
SO CORD W/ PLUG WIRED THRU HOOK

LENGTH	X=	120V	208V	240V	277V	480V	347V
-C4HLP (X)	4'	1	2	3	4	5	C
-C6HLP (X)	6'	1	2	3	4	5	C
-C8HLP (X)	8'	1	2	3	4	5	C
-C10HLP (X)	10'	1	2	3	4	5	C
-C12HLP (X)	12'	1	2	3	4	5	C

CORD, HOOK/LOOP & 15A PLUG W/ QUICK-ON® HANGER -
SO CORD W/ PLUG WIRED THRU HOOK

LENGTH	X=	120V	208V	240V	277V	480V	347V
-C4HLPX-15A	4'	1	2	3	4	5	C
-C6HLPX-15A	6'	1	2	3	4	5	C
-C8HLPX-15A	8'	1	2	3	4	5	C
-C10HLPX-15A	10'	1	2	3	4	5	C
-C12HLPX-15A	12'	1	2	3	4	5	C

-C4HLP1-15A	4' Cord, Hook/Loop & 15A 120V Plug w/ Quick-On® Hanger - SO cord w/ plug wired thru hook
-C6HLP1-15A	6' Cord, Hook/Loop & 15A 120V Plug w/ Quick-On® Hanger - SO cord w/ plug wired thru hook
-C8HLP1-15A	8' Cord, Hook/Loop & 15A 120V Plug w/ Quick-On® Hanger - SO cord w/ plug wired thru hook
-C10HLP1-15A	10' Cord, Hook/Loop & 15A 120V Plug w/ Quick-On® Hanger - SO cord w/ plug wired thru hook
-C12HLP1-15A	12' Cord, Hook/Loop & 15A 120V Plug w/ Quick-On® Hanger - SO cord w/ plug wired thru hook
-C4HLP4-15A	4' Cord, Hook/Loop & 15A 277V Plug w/ Quick-On® Hanger - SO cord w/ plug wired thru hook
-C6HLP4-15A	6' Cord, Hook/Loop & 15A 277V Plug w/ Quick-On® Hanger - SO cord w/ plug wired thru hook
-C8HLP4-15A	8' Cord, Hook/Loop & 15A 277V Plug w/ Quick-On® Hanger - SO cord w/ plug wired thru hook
-C10HLP4-15A	10' Cord, Hook/Loop & 15A 277V Plug w/ Quick-On® Hanger - SO cord w/ plug wired thru hook
-C12HLP4-15A	12' Cord, Hook/Loop & 15A 277V Plug w/ Quick-On® Hanger - SO cord w/ plug wired thru hook

CORD, HOOK/LOOP & 20A PLUG W/ SLICK-ON® HANGER -
SO CORD W/ PLUG WIRED THRU HOOK

LENGTH	X=	120V	208V	240V	277V	480V	347V
-C4HLPSO (X)	4'	1	2	3	4	5	C
-C6HLPSO (X)	6'	1	2	3	4	5	C
-C8HLPSO (X)	8'	1	2	3	4	5	C
-C10HLPSO (X)	10'	1	2	3	4	5	C
-C12HLPSO (X)	12'	1	2	3	4	5	C

Suffix	Description
-C4HLPSO1-15A	4' Cord, Hook/Loop & 15A 120V Plug w/ Slick-On® Hanger - SO cord w/ plug wired thru hook
-C6HLPSO1-15A	6' Cord, Hook/Loop & 15A 120V Plug w/ Slick-On® Hanger - SO cord w/ plug wired thru hook
-C8HLPSO1-15A	8' Cord, Hook/Loop & 15A 120V Plug w/ Slick-On® Hanger - SO cord w/ plug wired thru hook
-C10HLPSO1-15A	10' Cord, Hook/Loop & 15A 120V Plug w/ Slick-On® Hanger - SO cord w/ plug wired thru hook
-C12HLPSO1-15A	12' Cord, Hook/Loop & 15A 120V Plug w/ Slick-On® Hanger - SO cord w/ plug wired thru hook
-C4HLPSO4-15A	4' Cord, Hook/Loop & 15A 277V Plug w/ Slick-On® Hanger - SO cord w/ plug wired thru hook
-C6HLPSO4-15A	6' Cord, Hook/Loop & 15A 277V Plug w/ Slick-On® Hanger - SO cord w/ plug wired thru hook
-C8HLPSO4-15A	8' Cord, Hook/Loop & 15A 277V Plug w/ Slick-On® Hanger - SO cord w/ plug wired thru hook
-C10HLPSO4-15A	10' Cord, Hook/Loop & 15A 277V Plug w/ Slick-On® Hanger - SO cord w/ plug wired thru hook
-C12HLPSO4-15A	12' Cord, Hook/Loop & 15A 277V Plug w/ Slick-On® Hanger - SO cord w/ plug wired thru hook

CORD, HOOK/LOOP & 20A PLUG W/ SLICK-ON® HANGER -
SINGLE FUSE (incl.) SO CORD W/ PLUG WIRED THRU HOOK

LENGTH	X3=	120V	277V	347V
-C4HLPSOF (X3)	4'	1	4	C
-C6HLPSOF (X3)	6'	1	4	C
-C8HLPSOF (X3)	8'	1	4	C
-C10HLPSOF (X3)	10'	1	4	C
-C12HLPSOF (X3)	12'	1	4	C

CORD, HOOK/LOOP & 20A PLUG W/ SLICK-ON® HANGER -
DOUBLE FUSE (incl.) SO CORD W/ PLUG WIRED THRU HOOK

LENGTH	X4=	208V	240V	480V
-C4HLPSOFF (X4)	4'	2	3	5
-C6HLPSOFF (X4)	6'	2	3	5
-C8HLPSOFF (X4)	8'	2	3	5
-C10HLPSOFF (X4)	10'	2	3	5
-C12HLPSOFF (X4)	12'	2	3	5

-C4HLSO	4' Cord & Hook/Loop w/ Slick-On® Hanger - SO cord wired thru hook
-C6HLSO	6' Cord & Hook/Loop w/ Slick-On® Hanger - SO cord wired thru hook
-C8HLSO	8' Cord & Hook/Loop w/ Slick-On® Hanger - SO cord wired thru hook
-C10HLSO	10' Cord & Hook/Loop w/ Slick-On® Hanger - SO cord wired thru hook
-C12HLSO	12' Cord & Hook/Loop w/ Slick-On® Hanger - SO cord wired thru hook

Suffix	Description						
CORD, HOOK/LOOP W/ SLICK-ON® HANGER - SINGLE FUSE (incl.) SO CORD W/ PLUG WIRED THRU HOOK							
	LENGTH	X2=	120V	277V	347V		
-C4HLSOF (X2)	4'		1	4	C		
-C6HLSOF (X2)	6'		1	4	C		
-C8HLSOF (X2)	8'		1	4	C		
-C10HLSOF (X2)	10'		1	4	C		
-C12HLSOF (X2)	12'		1	4	C		
CORD, HOOK/LOOP W/ SLICK-ON® HANGER - DOUBLE FUSE (incl.) SO CORD W/ PLUG WIRED THRU HOOK							
	LENGTH	X3=	208V	240V	480V		
-C4HLSOFF (X3)	4'		2	3	5		
-C6HLSOFF (X3)	6'		2	3	5		
-C8HLSOFF (X3)	8'		2	3	5		
-C10HLSOFF (X3)	10'		2	3	5		
-C12HLSOFF (X3)	12'		2	3	5		
DEAD FRONT DISCONNECT - incl. CORD, LOOP & DEAD FRONT DISCONNECT PLUG W/ QUICK-ON® HANGER - 15" SO cord factory wired to fixture; order w/ PHS-XXXL (see mounting access.)							
		X1=	120V	208V	240V	480V 347V	
-DFP (X1)			1	2	3	4 5 F	
DEAD FRONT DISCONNECT W/ SINGLE FUSE - incl. CORD, LOOP & DEAD FRONT DISCONNECT PLUG PLUS SINGLE FUSE BLOCK (fuse incl.) W/ QUICK-ON® HANGER - 15" SO cord factory wired to fixture; order w/ PHS-XXXL (see mounting access.)							
		X3=	120V	277V	347V		
-DFPF (X3)			1	4	F		
DEAD FRONT DISCONNECT W/ DOUBLE FUSE - incl. CORD, LOOP & DEAD FRONT DISCONNECT PLUG PLUS DOUBLE FUSE BLOCK (fuse incl.) W/ QUICK-ON® HANGER - 15" SO cord factory wired to fixture; order w/ PHS-XXXL (see mounting access.)							
		X4=	208V	240V	480V		
-DFPFF (X4)			2	3	5		
DEAD FRONT DISCONNECT - incl. CORD, LOOP & DEAD FRONT DISCONNECT PLUG W/ SLICK-ON® HANGER - 15" SO cord factory wired to fixture; order w/ PHS-XXXL (see mounting access.)							
		X1=	120V	208V	240V	277V 480V 347V	
-DFPSO (X1)			1	2	3	4 5 F	
DEAD FRONT DISCONNECT W/ SINGLE FUSE - incl. CORD, LOOP & DEAD FRONT DISCONNECT PLUG PLUS SINGLE FUSE BLOCK (fuse incl.) W/ SLICK-ON® HANGER - 15" SO cord factory wired to fixture; order w/ PHS-XXXL (see mounting access.)							
		X3=	120V	277V	347V		
-DFPSOF (X3)			1	4	F		
DEAD FRONT DISCONNECT W/ DOUBLE FUSE - incl. CORD, LOOP & DEAD FRONT DISCONNECT PLUG PLUS DOUBLE FUSE BLOCK (fuse incl.) W/ SLICK-ON® HANGER - 15" SO cord factory wired to fixture; order w/ PHS-XXXL (see mounting access.) (not for Canada)							
		X3=	208V	240V	480V		
-DFPSOFF (X3)			2	3	5		
-LR	Tempered glass lens. Required with "E" rated lamps. Optional with "O" rated lamps.						

Suffix	Description						
-EM	Emergency Circuit Complete w/ Slick-On® hanger - D.C. bayonet base, 120V quartz socket; for connection by customer to separate power supply						
FLEXIBLE WIRE SYSTEM FIXTURE CORD (CANADA ONLY)							
	LENGTH	X1=	120V	208V	240V	277V 480V 347V	
-FC3X1	3'		1	2	3	4 5 C	
-FC6X1	6'		1	2	3	4 5 C	
-GR	Gray Lektrocote® Finish on housing; replace -WH in catalog number						
-JP	Job Pack - master carton packaging of ballast housing to reduce corrugated waste disposal; for shipment to jobsite only						
-LRI¹	Lower Luminaire Retainer - a snap-in cable on housing secures reflector to ballast housing						
-NMM	No Mounting Method - neither Slick-On® nor Quick-On® provided w/ luminaire. Mounting method must be ordered as an accessory; option used for applications requiring mounting method supplied in advance of luminaire						
-P	High Strength Polycarbonate Refractor						
-QSS	Quartz Standby System - ON when power is restored, OFF when HID lamp restrikes. Wattage of quartz lamp (included) limited to 250w max for 750w and higher HID fixtures and 150w max for lower wattage HID fixtures. Uses 120V DC bayonet base lamp. Factory wired.						
-QST	Quartz Standby with Time Delay - ON when power is restored, OFF when HID lamp restrikes and is warmed up. Wattage not to exceed wattage of HID lamp (250W max. recommended). Uses 120V DC bayonet base lamp. Factory wired.						
-SLD-1	Switch Level Dimming with 120V control						
-SLD-2	Switch Level Dimming with 24V control						
-SLD-3	Switch Level Dimming with 120 or 277V control (Direct Control)						
-SO	Slick-On® Thru Wire Outlet Box for 3/4" pendant or 1/2" or 3/4" side entry conduit						
SLICK-ON® THRU WIRE OUTLET BOX, SINGLE FUSE (incl.) for 3/4" pendant or side entry conduit							
		X3=	120V	277V	347V		
-SOF (X3)			1	4	F		
SLICK-ON® THRU WIRE OUTLET BOX, DOUBLE FUSE (incl.) for 3/4" pendant or side entry conduit (not for Canada)							
		X4=	208V	240V	480V		
-SOFF (X4)			2	3	5		
-TRI(X)	Top Luminaire Retainer - chain secures ballast housing to structure when additional safety precautions are required. Shipped in housing carton. Specify length (X), recommended maximum slack is 3"						

¹ Luminaire retainers/safety cables reduce risk of equipment falling

NOTE: For specific applications, bottom enclosures may be required. For more information, please see specific lamp manufacturers' data and the NEMA white paper "Best Practices for Metal Halide Lighting Systems" posted on the NEMA web site (www.nema.org).

WARNING: Improper selection, installation, operation, servicing, removal, and disposal of lighting products may create serious hazardous including fires, explosions, shock, burns, cuts, impaired vision, falling objects, and environmental contamination. Reduce risks by using the guidance of licensed professionals throughout the product life cycle, and following individual product, component, and accessory safety instructions and labels.

We offer this in the interest of safety for our customers, who may not be aware of the potentially high risk involved in the misuse of these products.

ORDERING INFORMATION

ACCESSORIES

(order separately)

Catalog #	Description
B-LLR¹	Lower Luminaire Retainer - 2' cable secures reflector to ballast housing
B-TLR(6)¹	6' Top Luminaire Retainer - chain secures ballast housing to structure when additional safety precautions are required
B-TLR(10)¹	10' Top Luminaire Retainer - chain secures ballast housing to structure when additional safety precautions are required
B-TLR(12)¹	12' Top Luminaire Retainer - chain secures ballast housing to structure when additional safety precautions are required
B-TLR(16)¹	16' Top Luminaire Retainer - chain secures ballast housing to structure when additional safety precautions are required
BL-LR-14²	Tempered Glass Lens - thermal shock & impact resistant; gasketed on corrosion-resistant steel lens ring (not dust tight) required for 175, 250, 320, 350 & 400 watt metal halide luminaires; for BI and BC reflector only
BL-QO	Quick-On 3/4" pendant mount
BL-SO	Slick-On Thru Wire Outlet Box for 3/4" pendant or 3/4, 1/2 side entry conduit
BL-SOF	Slick-On Single Fusing (fuse not incl.) thru wire outlet box for 3/4" pendant or 3/4, 1/2 side entry conduit mount with single fuse holder
BL-SOFF	Slick-On Double Fusing (fuses not incl.) thru wire outlet box for 3/4" pendant or 3/4, 1/2 side entry conduit mount with double fuse holder (not for Canada)
WG-14	14" Wireguard - corrosion resistant, welded steel w/ center lamp access

1 Luminaire retainers/safety cables reduce risk of equipment falling.

2 Bottom enclosures are required unless lamps designated as "suitable for open use" are used.

MOUNTING ACCESSORIES

(order separately)

PLUGS ARE TWIST-LOCK® TYPE AS MANUFACTURED BY HUBBELL WIRING DEVICES.

Catalog #	Description
BLA-C4HLP-1	4' Cord, Hook/Loop and 120V 20A Twist-Lock® Plug
BLA-C4HLP-4	4' Cord, Hook/Loop and 277V 20A Twist-Lock® Plug
BLA-C4HLP1-15A	4' Cord, Hook/Loop and 120V 15A Twist-Lock® Plug
BLA-C4HLP4-15A	4' Cord, Hook/Loop and 277V 15A Twist-Lock® Plug
HOOK/LOOP¹	Hook - cast aluminum 3/4" NPS male; includes safety screw; converts to Loop with strap included
H3/4AL3/4¹	Swivel Aligner - complete with box for thru wiring; all hubs tapped for 3/4" conduit - 25° swivel
PHE-XXX¹	Die Cast Aluminum Power Hook with 20A Twist-Lock® Receptacle - ceiling or 3/4" pendant mount, with 3/4" side entry for thru wiring 15" Cord, Hook/Loop & Twist-Lock® Plug (20 amp) included (for voltage replace XXX with 120, 208, 240, 277, 347, or 480)
PHE-XXX-L²	As above, except cord, loop & plug not included (for voltage replace XXX with 120, 208, 240, 277, 347, or 480)
PHS-XXX	Specification Grade Power Hook - 30" cord dead front plug & receptacle with isolated wiring chamber; ceiling or 3/4" pendant mount, with 3/4" side entry for thru wiring; special safety feature locks Hook/Loop onto bottom hook (for voltage replace XXX with 120, 208, 240, 277, 347, or 480)
PHS-XXX-L^{1,3}	Specification Grade Power Hook - dead front receptacle with isolated wiring chamber; ceiling or 3/4" pendant mount, with 3/4" side entry for thru wiring; Cord, Hook/Loop and Dead Front Plug not included, must be ordered with luminaire (for voltage replace XXX with 120, 208, 240, 277, 347, or 480)
SY3-XXX-2	Rugged Steel Power Hook with 20A Twist-Lock® Receptacle - pendant or surface mount, 3/4" thru wiring capability; 30" Cord, Hook/Loop and Plug (20 amp) included (for voltage replace XXX with 120, 208, 240, 277, 347, or 480)
SY3-XXX-L²	Porta-Hook includes integral mounting hook and 20A Twist-Lock® Receptacle; 3/4" knockouts on top and two sides; Cord, Hook/Loop and Plug (20 amp) not included (for voltage replace XXX with 120, 208, 240, 277, 347, or 480)

1 CSA certified.

2 Cord, Hook/Loop and Plug must be added to fixture as option, example: **-C2HLP4**.

3 Cord, Hook/Loop and Dead Front Plug must be added to fixture as option, example: **-DFP4**.
NOTE: Cord used with above accessories is 16/3 SOWA 105°C NEMA configurations.

QUICK ESTIMATOR BL-BI

LAMP QTY-LU/LP INPUT WATTS	SC @2/@4 LLF TEST #	ROOM WIDTH -/- MOUNTING HEIGHT (above floor)	ILLUMINANCE (MAINTAINED)				
			APPROXIMATE AREA PER LUMINAIRE (SQ. FT.) / APPROXIMATE WATTS PER SQ. FT. (w/Blst. Losses)				
			10 fc	20 fc	50 fc	75 fc	100 fc
MH250/U (ENC)	1.5/1.5	5 or more	884 / 0.33	442 / 0.66	177 / 1.64	118 / 2.46	n.r. / n.r.
1 @ 20500	0.54	2	663 / 0.44	332 / 0.87	133 / 2.19	88 / 3.28	n.r. / n.r.
290	HP-03848A	1	497 / 0.58	249 / 1.17	99 / 2.91	66 / 4.37	n.r. / n.r.
MS400/BU/PS	1.3/1.4	5 or more	2238 / 0.20	1119 / 0.40	448 / 1.01	298 / 1.51	224 / 2.02
1 @ 44000	0.60	2	1659 / 0.27	830 / 0.54	332 / 1.36	221 / 2.04	166 / 2.72
452	HP-03802	1	1238 / 0.37	619 / 0.73	248 / 1.83	165 / 2.74	124 / 3.65
MH400/U	1.3/1.4	5 or more	1753 / 0.26	876 / 0.52	351 / 1.31	234 / 1.96	175 / 2.61
1 @ 36000	0.57	2	1299 / 0.35	650 / 0.71	260 / 1.76	173 / 2.64	130 / 3.53
458	HP-03802	1	969 / 0.47	485 / 0.95	194 / 2.36	129 / 3.54	97 / 4.73

To determine the number of luminaires required for a given illuminance level:

Step 1: Determine room size per column three below as 5 or more (Large Room), 2 (Medium Room) or 1 (Small Room).

Step 2: For desired footcandle level, per room size, divide floor area of space by "Approximate Area per Luminaire" from chart.

Step 3: If required, adjust result of Step 2 to "whole number." Result is quantity of luminaires required to provide approximate, average maintained illuminance selected.

Due to our continued efforts to improve our products, product specifications are subject to change without notice.



Industrial Lighting

Hubbell Industrial Lighting • 701 Millennium Boulevard • Greenville, SC 29607 • PHONE: 864-678-1000

For more information visit our web site: www.hubbell-iltg.com