

Chain

Wire & Hangers

Jack Chain • Bright Galvanized - PC 5000

Jack chain is used for suspending fixtures. Steel Material.

CAT NO	GAUGE	DIAMETER	WORK LOAD	BREAK LOAD	SIZE	STD
CH1010	#10	.135	43 lbs	170 lbs	#10	100'
CH10P (Pail)	#10	.135	43 lbs	170 lbs	#10	300'
CH1212	#12	.105	29 lbs	115 lbs	#12	100'
CH12P (Pail)	#12	.105	29 lbs	115 lbs	#12	300'
CH1414	#14	.080	16 lbs	65 lbs	#14	100'
CH1616	#16	.080	10 lbs	40 lbs	#16	100'

Double Loop Jack Chain - PC 5010

Double loop is a locked link chain with higher load ratings than jack chain. Because the links cannot be opened it requires the use of the S hook. Locked Link, Steel.

CAT NO	GAUGE	DIAMETER	WORK LOAD	BREAK LOAD	SIZE	STD
DL2/0	#10	.135	255 lbs	1020 lbs	#2/0	100'
DL1/0	#11	.120	200 lbs	800 lbs	#1/0	100'
DL1	#12	.105	155 lbs	620 lbs	#1	100'
DL2	#13	.091	115 lbs	460 lbs	#2	100'
DL3	#14	.080	90 lbs	360 lbs	#3	100'

Installation Procedure for Hanging Chain

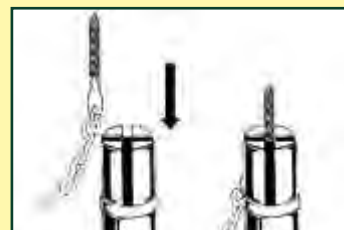

Secure a #1 1/2 "S" hook to an acoustical eye lag and to the proper size chain for your job. Insert it into the Telescoping Pole Tool.

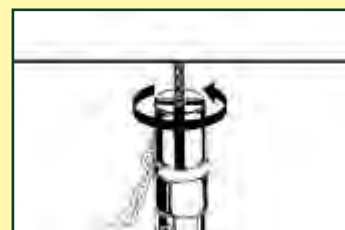

Secure a the chain in the magazine so it does not whip when rotating the pole. Now rotate the eye lag screw until it is seated.

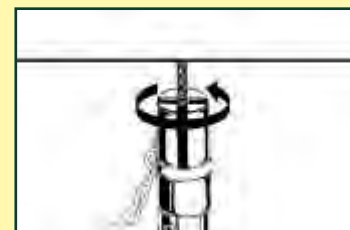

Lower the Telescoping Pole Tool.

"S" Hooks - PC 4870

"S" Hooks are manufactured from low carbon cold drawn steel wire supplied with blunt ends and zinc plated. Hooks are used to hang fixtures suspended from chain.

CAT NO	OVERALL LENGTH (L)	DIAMETER EYE (C)	DIAMETER OPENING (E)	WIRE GAUGE (D)	STD
S1	1"	1/4"	3/16"	11 Ga.	100
S2	1-1/2"	7/16"	1/4"	7 Ga.	100
S3	2"	9/16"	3/8"	1/4"	50
S4	2-1/2"	3/4"	7/16"	5/16"	50
S5	3"	7/8"	1/2"	5/16"	50

Pre-Tied Ceiling Wire With Clip - PC 4385

Pre-Tied Ceiling Wires are installed with low velocity powder actuated tools in poured concrete deck.

- 12 Gauge Wire • Includes 1-1/4" Pin & Clip • Galvanized Finish • ICC# ESR1530

CAT NO	DESCRIPTION	STD
*CWC6	6' Pre-Tied ceiling wire with 1-1/4" Pin & Clip	100
*CWC8	8' Pre-Tied ceiling wire with 1-1/4" Pin & Clip	100
*CWC10	10' Pre-Tied ceiling wire with 1-1/4" Pin & Clip	100

* Powder Activated Pole Tools Available



Ceiling Wire - PC 4385

Ceiling Wires are installed with low velocity powder actuated tools in poured concrete deck.

- 12 Gauge Wire • Galvanized Finish • ICC# ESR1530

CAT NO	DESCRIPTION	STD
CWS6	Ceiling Wire 6' Straight	100
CWS8	Ceiling Wire 8' Straight	100
CWS10	Ceiling Wire 10' Straight	100



Flat Hanger Screws - PC 4920

- Flat Hanger Screws
- TK - With Drill Pt.

CAT NO	DESCRIPTION	STD
631	1/4 x 3"	100
631TK	1/4 x 2"	100



Installation Procedure for Hanging Wire



Adjust the telescoping tubes to the proper lengths.



Insert 1/4" x 3" acoustical lag screw into top slot.



Insert wire into side of slot, through the hold in the lag screw. Then bend the wire end down.

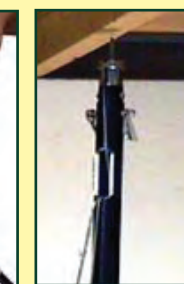

Raise tool against beam or joist, rotate Telescoping Pole Tool until the Lag is at least 1" into the wood.



Lower the tool about two inches as shown



Rotate the tool again to twist the wire. Telescoping Pole Tool may be turned by hand or by using a 1/2" variable speed drill. Caution: if using drill, do not grip pole tightly with hand, but allow it to turn loosely.