

ACCN-04-90HB12  
Non-Ventilated Horizontal Bend

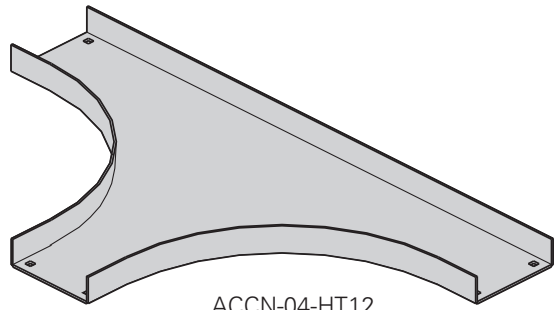

ACCN-04-HT12  
Non-Ventilated Tee

Fittings engineered with 3" tangents for splicing integrity.

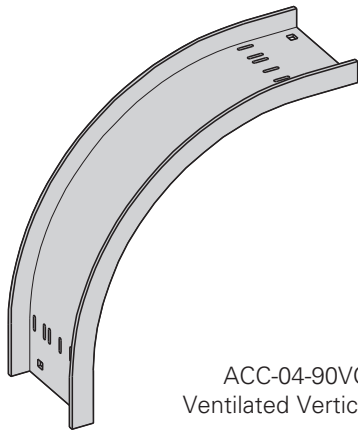

ACC-04-90VO12  
Ventilated Vertical Bend

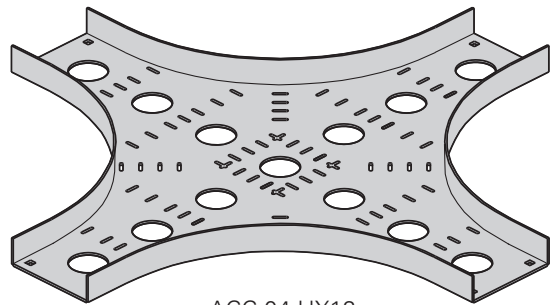

ACC-04-HX12  
Ventilated Horizontal Cross

## Fittings Part Numbering

Example: <sup>Prefix</sup> **A C C N - 04 - 90 H B 24**

**Material**

**Tray Type**

**Width**

**Angle**

**Fitting Type**

**Radius**

- A = Aluminum
- G = Type 1 HDGAF
- SS4 = 304 Stainless Steel
- SS6 = 316 Stainless Steel
- P = †

- \*CC = Ventilated Cable Channel
- CCN = Non-ventilated Cable Channel

- 03 = 3"
- 04 = 4"
- 06 = 6"

- 30 = 30°
- 45 = 45°
- 60 = 60°
- 90 = 90°

- HB = Horizontal Bend
- HT = Horizontal Tee
- HX = Horizontal Cross
- VI = Vertical Inside Bend
- VO = Vertical Outside Bend

- 12 = 12"
- 24 = 24"
- 36 = 36"
- 48 = 48"

\* Ventilated Cable Channel Fittings are available only in 12" and 24" radii.

† - Due to multiple piece welded construction, P fittings are not available - substitute G.

**All items normal lead time except for those indicated**

● Green = Fastest shipped items    ● Black = Normal lead-time items    ● Red = Normally long lead-time items

All dimensions in shaded areas are millimeters unless otherwise specified.

# Channel Cable Tray - Fittings

## Horizontal Bends 90°, 60° (HB)

1 splice plate with hardware included.

Bend Radius R	Tray Width	90° Horizontal Bend Dimensions			
		Catalog No.	A	B	C
in. (mm)	in. (mm)		in. (mm)	in. (mm)	in. (mm)
12 (305)	3 (76)	<b>(Pre)-03-90HB12</b>	16 <sup>1</sup> / <sub>2</sub> (419)	16 <sup>1</sup> / <sub>2</sub> (419)	16 <sup>1</sup> / <sub>2</sub> (419)
	4 (101)	<b>(Pre)-04-90HB12</b>	17 (432)	17 (432)	17 (432)
	6 (152)	<b>(Pre)-06-90HB12</b>	18 (457)	18 (457)	18 (457)
24 (609)	3 (76)	<b>(Pre)-03-90HB24</b>	28 <sup>1</sup> / <sub>2</sub> (723)	28 <sup>1</sup> / <sub>2</sub> (723)	28 <sup>1</sup> / <sub>2</sub> (723)
	4 (101)	<b>(Pre)-04-90HB24</b>	29 (737)	29 (737)	29 (737)
	6 (152)	<b>(Pre)-06-90HB24</b>	30 (762)	30 (762)	30 (762)
36 (915)	3 (76)	<b>(Pre)-03-90HB36</b>	40 <sup>1</sup> / <sub>2</sub> (1029)	40 <sup>1</sup> / <sub>2</sub> (1029)	40 <sup>1</sup> / <sub>2</sub> (1029)
	4 (101)	<b>(Pre)-04-90HB36</b>	41 (1041)	41 (1041)	41 (1041)
	6 (152)	<b>(Pre)-06-90HB36</b>	42 (1067)	42 (1067)	42 (1067)
48 (1218)	3 (76)	<b>(Pre)-03-90HB48</b>	52 <sup>1</sup> / <sub>2</sub> (1334)	52 <sup>1</sup> / <sub>2</sub> (1334)	52 <sup>1</sup> / <sub>2</sub> (1334)
	4 (101)	<b>(Pre)-04-90HB48</b>	53 (1346)	53 (1346)	53 (1346)
	6 (152)	<b>(Pre)-06-90HB48</b>	54 (1372)	54 (1372)	54 (1372)

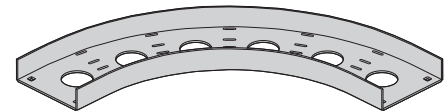

90° Horizontal Bend  
Ventilated Horizontal Bend

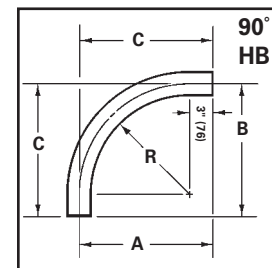

60° Horizontal Bend					
Bend Radius R	Tray Width	Catalog No.	A	B	C
in. (mm)	in. (mm)		in. (mm)	in. (mm)	in. (mm)
12 (305)	3 (76)	<b>(Pre)-03-60HB12</b>	16 <sup>1</sup> / <sub>4</sub> (412)	9 <sup>3</sup> / <sub>8</sub> (239)	10 <sup>3</sup> / <sub>4</sub> (273)
	4 (101)	<b>(Pre)-04-60HB12</b>	16 <sup>5</sup> / <sub>8</sub> (422)	9 <sup>5</sup> / <sub>8</sub> (245)	11 <sup>1</sup> / <sub>8</sub> (283)
	6 (152)	<b>(Pre)-06-60HB12</b>	17 <sup>1</sup> / <sub>2</sub> (445)	10 (254)	11 <sup>5</sup> / <sub>8</sub> (296)
24 (609)	3 (76)	<b>(Pre)-03-60HB24</b>	26 <sup>5</sup> / <sub>8</sub> (676)	15 <sup>3</sup> / <sub>8</sub> (391)	17 <sup>3</sup> / <sub>4</sub> (451)
	4 (101)	<b>(Pre)-04-60HB24</b>	27 (686)	15 <sup>5</sup> / <sub>8</sub> (397)	18 (450)
	6 (152)	<b>(Pre)-06-60HB24</b>	27 <sup>7</sup> / <sub>8</sub> (708)	16 (406)	18 <sup>5</sup> / <sub>8</sub> (466)
36 (915)	3 (76)	<b>(Pre)-03-60HB36</b>	37 (940)	21 <sup>3</sup> / <sub>8</sub> (543)	24 <sup>5</sup> / <sub>8</sub> (625)
	4 (101)	<b>(Pre)-04-60HB36</b>	37 <sup>3</sup> / <sub>8</sub> (949)	21 <sup>5</sup> / <sub>8</sub> (549)	25 (635)
	6 (152)	<b>(Pre)-06-60HB36</b>	38 <sup>1</sup> / <sub>4</sub> (972)	22 (559)	25 <sup>1</sup> / <sub>2</sub> (648)
48 (1218)	3 (76)	<b>(Pre)-03-60HB48</b>	47 <sup>3</sup> / <sub>8</sub> (1203)	27 <sup>3</sup> / <sub>8</sub> (695)	31 <sup>5</sup> / <sub>8</sub> (803)
	4 (101)	<b>(Pre)-04-60HB48</b>	47 <sup>7</sup> / <sub>8</sub> (1216)	27 <sup>5</sup> / <sub>8</sub> (702)	31 <sup>7</sup> / <sub>8</sub> (810)
	6 (152)	<b>(Pre)-06-60HB48</b>	48 <sup>5</sup> / <sub>8</sub> (1235)	28 (711)	32 <sup>1</sup> / <sub>2</sub> (826)

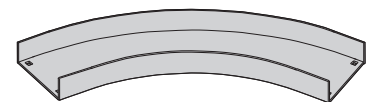

60° Horizontal Bend  
Non-Ventilated Horizontal Bend

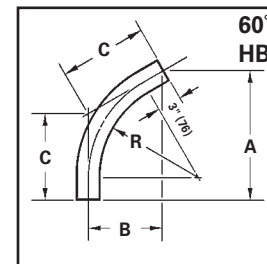

(Pre) See page E-10 for catalog number prefix.

All dimensions in shaded areas are millimeters unless otherwise specified.

## Horizontal Bends 45°, 30° (HB)

1 splice plate with hardware included.



45° Horizontal Bend  
Ventilated Horizontal Bend

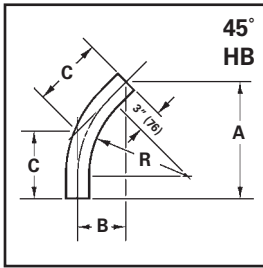

30° Horizontal Bend  
Non-Ventilated Horizontal Bend

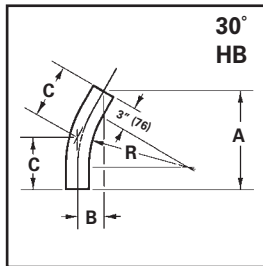

Bend Radius R	Tray Width	45° Horizontal Bend Dimensions			
		Catalog No.	A	B	C
in. (mm)	in. (mm)		in. (mm)	in. (mm)	in. (mm)
12 (305)	3 (76)	<b>(Pre)-03-45HB12</b>	14 <sup>5</sup> / <sub>8</sub> (371)	6 <sup>1</sup> / <sub>8</sub> (156)	8 <sup>5</sup> / <sub>8</sub> (219)
	4 (101)	<b>(Pre)-04-45HB12</b>	15 (381)	6 <sup>1</sup> / <sub>4</sub> (159)	8 <sup>7</sup> / <sub>8</sub> (225)
	6 (152)	<b>(Pre)-06-45HB12</b>	15 <sup>3</sup> / <sub>4</sub> (400)	6 <sup>1</sup> / <sub>2</sub> (165)	9 <sup>1</sup> / <sub>4</sub> (235)
24 (609)	3 (76)	<b>(Pre)-03-45HB24</b>	23 <sup>1</sup> / <sub>8</sub> (587)	9 <sup>5</sup> / <sub>8</sub> (244)	13 <sup>5</sup> / <sub>8</sub> (346)
	4 (101)	<b>(Pre)-04-45HB24</b>	23 <sup>1</sup> / <sub>2</sub> (597)	9 <sup>3</sup> / <sub>4</sub> (248)	13 <sup>3</sup> / <sub>4</sub> (349)
	6 (152)	<b>(Pre)-06-45HB24</b>	24 <sup>1</sup> / <sub>8</sub> (613)	10 (254)	14 <sup>1</sup> / <sub>8</sub> (359)
36 (915)	3 (76)	<b>(Pre)-03-45HB36</b>	31 <sup>5</sup> / <sub>8</sub> (803)	13 <sup>1</sup> / <sub>8</sub> (334)	18 <sup>5</sup> / <sub>8</sub> (473)
	4 (101)	<b>(Pre)-04-45HB36</b>	32 (813)	13 <sup>1</sup> / <sub>4</sub> (337)	18 <sup>3</sup> / <sub>4</sub> (476)
	6 (152)	<b>(Pre)-06-45HB36</b>	32 <sup>3</sup> / <sub>4</sub> (832)	13 <sup>1</sup> / <sub>2</sub> (343)	19 <sup>1</sup> / <sub>8</sub> (486)
48 (1218)	3 (76)	<b>(Pre)-03-45HB48</b>	40 <sup>1</sup> / <sub>8</sub> (1019)	16 <sup>5</sup> / <sub>8</sub> (422)	23 <sup>1</sup> / <sub>2</sub> (597)
	4 (101)	<b>(Pre)-04-45HB48</b>	40 <sup>1</sup> / <sub>2</sub> (1029)	16 <sup>3</sup> / <sub>4</sub> (425)	23 <sup>3</sup> / <sub>4</sub> (603)
	6 (152)	<b>(Pre)-06-45HB48</b>	41 <sup>1</sup> / <sub>8</sub> (1045)	17 (432)	24 <sup>1</sup> / <sub>8</sub> (613)

30° Horizontal Bend					
Bend Radius R	Tray Width	Catalog No.	A	B	C
			in. (mm)	in. (mm)	in. (mm)
12 (305)	3 (76)	<b>(Pre)-03-30HB12</b>	12 <sup>3</sup> / <sub>8</sub> (314)	3 <sup>1</sup> / <sub>4</sub> (83)	6 <sup>5</sup> / <sub>8</sub> (168)
	4 (101)	<b>(Pre)-04-30HB12</b>	12 <sup>5</sup> / <sub>8</sub> (321)	3 <sup>3</sup> / <sub>8</sub> (86)	6 <sup>3</sup> / <sub>4</sub> (171)
	6 (152)	<b>(Pre)-06-30HB12</b>	13 <sup>1</sup> / <sub>8</sub> (334)	3 <sup>1</sup> / <sub>2</sub> (89)	7 (178)
24 (609)	3 (76)	<b>(Pre)-03-30HB24</b>	18 <sup>3</sup> / <sub>8</sub> (467)	4 <sup>7</sup> / <sub>8</sub> (124)	9 <sup>7</sup> / <sub>8</sub> (251)
	4 (101)	<b>(Pre)-04-30HB24</b>	18 <sup>5</sup> / <sub>8</sub> (473)	5 (127)	10 (254)
	6 (152)	<b>(Pre)-06-30HB24</b>	19 <sup>1</sup> / <sub>8</sub> (486)	5 <sup>1</sup> / <sub>8</sub> (130)	10 <sup>1</sup> / <sub>4</sub> (260)
36 (915)	3 (76)	<b>(Pre)-03-30HB36</b>	24 <sup>3</sup> / <sub>8</sub> (619)	6 <sup>1</sup> / <sub>2</sub> (165)	13 (330)
	4 (101)	<b>(Pre)-04-30HB36</b>	24 <sup>5</sup> / <sub>8</sub> (626)	6 <sup>5</sup> / <sub>8</sub> (168)	13 <sup>1</sup> / <sub>8</sub> (334)
	6 (152)	<b>(Pre)-06-30HB36</b>	25 <sup>1</sup> / <sub>8</sub> (638)	6 <sup>3</sup> / <sub>4</sub> (171)	13 <sup>1</sup> / <sub>2</sub> (343)
48 (1218)	3 (76)	<b>(Pre)-03-30HB48</b>	30 <sup>3</sup> / <sub>8</sub> (772)	8 <sup>1</sup> / <sub>8</sub> (207)	16 <sup>1</sup> / <sub>4</sub> (413)
	4 (101)	<b>(Pre)-04-30HB48</b>	30 <sup>5</sup> / <sub>8</sub> (778)	8 <sup>1</sup> / <sub>4</sub> (210)	16 <sup>3</sup> / <sub>8</sub> (416)
	6 (152)	<b>(Pre)-06-30HB48</b>	31 <sup>1</sup> / <sub>8</sub> (791)	8 <sup>3</sup> / <sub>8</sub> (213)	16 <sup>5</sup> / <sub>8</sub> (422)

**(Pre)** See page E-10 for catalog number prefix.

All dimensions in shaded areas are millimeters unless otherwise specified.

# Channel Cable Tray - Fittings

## Horizontal Tee (HT)

2 splice plates with hardware included.

Bend Radius R in. (mm)	Tray Width in. (mm)	Horizontal Tee Dimensions		
		Catalog No.	A in. (mm)	B in. (mm)
12 (305)	3 (76)	(Pre)-03-HT12	16 <sup>1</sup> / <sub>2</sub> (419)	33 (838)
	4 (101)	(Pre)-04-HT12	17 (432)	34 (864)
	6 (152)	(Pre)-06-HT12	18 (457)	36 (914)
24 (609)	3 (76)	(Pre)-03-HT24	28 <sup>1</sup> / <sub>2</sub> (723)	57 (1448)
	4 (101)	(Pre)-04-HT24	29 (737)	58 (1473)
	6 (152)	(Pre)-06-HT24	30 (762)	60 (1524)
36 (915)	3 (76)	(Pre)-03-HT36	40 <sup>1</sup> / <sub>2</sub> (1029)	81 (2057)
	4 (101)	(Pre)-04-HT36	41 (1041)	82 (2083)
	6 (152)	(Pre)-06-HT36	42 (1067)	84 (2134)
48 (1218)	3 (76)	(Pre)-03-HT48	52 <sup>1</sup> / <sub>2</sub> (1334)	105 (2667)
	4 (101)	(Pre)-04-HT48	53 (1346)	106 (2692)
	6 (152)	(Pre)-06-HT48	54 (1372)	108 (2743)

(Pre) See page E-10 for catalog number prefix.

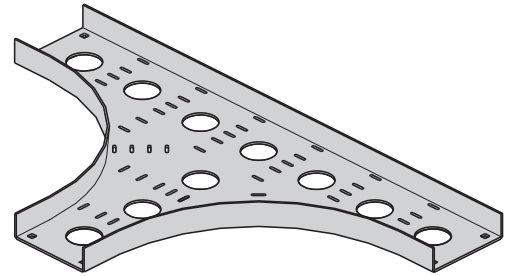

Horizontal Tee  
Ventilated Horizontal Tee

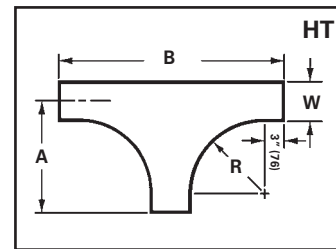

## Horizontal Cross (HX)

3 splice plates with hardware included.

Bend Radius R in. (mm)	Tray Width in. (mm)	Horizontal Cross Dimensions		
		Catalog No.	A in. (mm)	B in. (mm)
12 (305)	3 (76)	(Pre)-03-HX12	16 <sup>1</sup> / <sub>2</sub> (419)	33 (838)
	4 (101)	(Pre)-04-HX12	17 (432)	34 (864)
	6 (152)	(Pre)-06-HX12	18 (457)	36 (914)
24 (609)	3 (76)	(Pre)-03-HX24	28 <sup>1</sup> / <sub>2</sub> (723)	57 (1448)
	4 (101)	(Pre)-04-HX24	29 (737)	58 (1473)
	6 (152)	(Pre)-06-HX24	30 (762)	60 (1524)
36 (915)	3 (76)	(Pre)-03-HX36	40 <sup>1</sup> / <sub>2</sub> (1029)	81 (2057)
	4 (101)	(Pre)-04-HX36	41 (1041)	82 (2083)
	6 (152)	(Pre)-06-HX36	42 (1067)	84 (2134)
48 (1218)	3 (76)	(Pre)-03-HX48	52 <sup>1</sup> / <sub>2</sub> (1334)	105 (2667)
	4 (101)	(Pre)-04-HX48	53 (1346)	106 (2692)
	6 (152)	(Pre)-06-HX48	54 (1372)	108 (2743)

(Pre) See page E-10 for catalog number prefix.

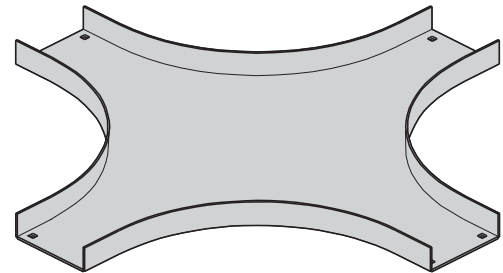

Horizontal Cross  
Non-Ventilated Horizontal Cross

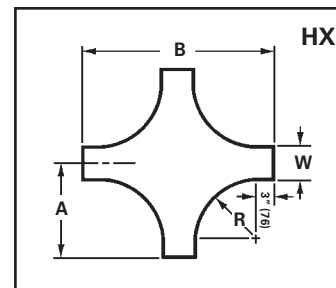

All dimensions in shaded areas are millimeters unless otherwise specified.

## Vertical Outside Bends 90°, 60° (VO)

1 splice plate with hardware included.

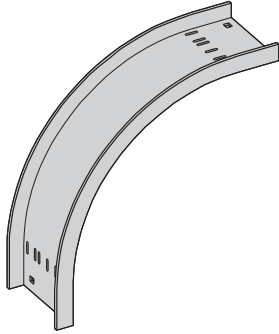

90° Vertical Outside Bend  
Ventilated Vertical Outside Bend

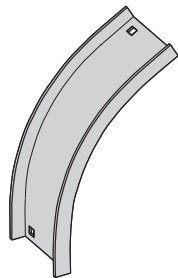
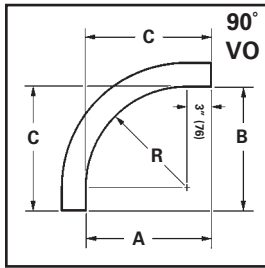

60° Vertical Outside Bend  
Non-Ventilated Vertical Outside Bend

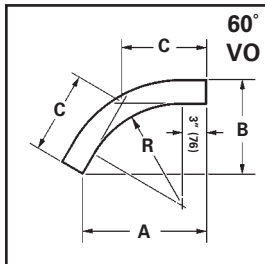

Bend Radius R	Tray Width	90° Vertical Outside Bend Dimensions			
		Catalog No.	A	B	C
in. (mm)	in. (mm)		in. (mm)	in. (mm)	in. (mm)
12 (305)	3 (76)	<b>(Pre)-03-90VO12</b>	15 (381)	15 (381)	15 (381)
	4 (101)	<b>(Pre)-04-90VO12</b>	15 (381)	15 (381)	15 (381)
	6 (152)	<b>(Pre)-06-90VO12</b>	15 (381)	15 (381)	15 (381)
24 (609)	3 (76)	<b>(Pre)-03-90VO24</b>	27 (686)	27 (686)	27 (686)
	4 (101)	<b>(Pre)-04-90VO24</b>	27 (686)	27 (686)	27 (686)
	6 (152)	<b>(Pre)-06-90VO24</b>	27 (686)	27 (686)	27 (686)
36 (915)	3 (76)	<b>(Pre)-03-90VO36</b>	39 (991)	39 (991)	39 (991)
	4 (101)	<b>(Pre)-04-90VO36</b>	39 (991)	39 (991)	39 (991)
	6 (152)	<b>(Pre)-06-90VO36</b>	39 (991)	39 (991)	39 (991)
48 (1218)	3 (76)	<b>(Pre)-03-90VO48</b>	51 (1295)	51 (1295)	51 (1295)
	4 (101)	<b>(Pre)-04-90VO48</b>	51 (1295)	51 (1295)	51 (1295)
	6 (152)	<b>(Pre)-06-90VO48</b>	51 (1295)	51 (1295)	51 (1295)

60° Vertical Outside Bend					
Bend Radius R	Tray Width	Catalog No.	A	B	C
			in. (mm)	in. (mm)	in. (mm)
12 (305)	3 (76)	<b>(Pre)-03-60VO12</b>	14 <sup>7</sup> / <sub>8</sub> (378)	8 <sup>1</sup> / <sub>2</sub> (216)	9 <sup>7</sup> / <sub>8</sub> (251)
	4 (101)	<b>(Pre)-04-60VO12</b>	14 <sup>7</sup> / <sub>8</sub> (378)	8 <sup>1</sup> / <sub>2</sub> (216)	9 <sup>7</sup> / <sub>8</sub> (251)
	6 (152)	<b>(Pre)-06-60VO12</b>	14 <sup>7</sup> / <sub>8</sub> (378)	8 <sup>1</sup> / <sub>2</sub> (216)	9 <sup>7</sup> / <sub>8</sub> (251)
24 (609)	3 (76)	<b>(Pre)-03-60VO24</b>	25 <sup>3</sup> / <sub>8</sub> (645)	14 <sup>5</sup> / <sub>8</sub> (372)	16 <sup>7</sup> / <sub>8</sub> (428)
	4 (101)	<b>(Pre)-04-60VO24</b>	25 <sup>3</sup> / <sub>8</sub> (645)	14 <sup>5</sup> / <sub>8</sub> (372)	16 <sup>7</sup> / <sub>8</sub> (428)
	6 (152)	<b>(Pre)-06-60VO24</b>	25 <sup>3</sup> / <sub>8</sub> (645)	14 <sup>5</sup> / <sub>8</sub> (372)	16 <sup>7</sup> / <sub>8</sub> (428)
36 (915)	3 (76)	<b>(Pre)-03-60VO36</b>	35 <sup>3</sup> / <sub>8</sub> (905)	20 <sup>5</sup> / <sub>8</sub> (524)	23 <sup>3</sup> / <sub>4</sub> (603)
	4 (101)	<b>(Pre)-04-60VO36</b>	35 <sup>3</sup> / <sub>8</sub> (905)	20 <sup>5</sup> / <sub>8</sub> (524)	23 <sup>3</sup> / <sub>4</sub> (603)
	6 (152)	<b>(Pre)-06-60VO36</b>	35 <sup>3</sup> / <sub>8</sub> (905)	20 <sup>5</sup> / <sub>8</sub> (524)	23 <sup>3</sup> / <sub>4</sub> (603)
48 (1218)	3 (76)	<b>(Pre)-03-60VO48</b>	46 <sup>1</sup> / <sub>8</sub> (1172)	26 <sup>5</sup> / <sub>8</sub> (676)	30 <sup>3</sup> / <sub>4</sub> (781)
	4 (101)	<b>(Pre)-04-60VO48</b>	46 <sup>1</sup> / <sub>8</sub> (1172)	26 <sup>5</sup> / <sub>8</sub> (676)	30 <sup>3</sup> / <sub>4</sub> (781)
	6 (152)	<b>(Pre)-06-60VO48</b>	46 <sup>1</sup> / <sub>8</sub> (1172)	26 <sup>5</sup> / <sub>8</sub> (676)	30 <sup>3</sup> / <sub>4</sub> (781)

(Pre) See page E-10 for catalog number prefix.

All dimensions in shaded areas are millimeters unless otherwise specified.

# Channel Cable Tray - Fittings

## Vertical Outside Bends 45°, 30° (VO)

1 splice plate with hardware included.

Bend Radius R	Tray Width	45° Vertical Outside Bend Dimensions			
		Catalog No.	A	B	C
in. (mm)	in. (mm)		in. (mm)	in. (mm)	in. (mm)
12 (305)	3 (76)	<b>(Pre)-03-45VO12</b>	13 <sup>5</sup> / <sub>8</sub> (346)	5 <sup>5</sup> / <sub>8</sub> (143)	8 (203)
	4 (101)	<b>(Pre)-04-45VO12</b>	13 <sup>5</sup> / <sub>8</sub> (346)	5 <sup>5</sup> / <sub>8</sub> (143)	8 (203)
	6 (152)	<b>(Pre)-06-45VO12</b>	13 <sup>5</sup> / <sub>8</sub> (346)	5 <sup>5</sup> / <sub>8</sub> (143)	8 (203)
24 (609)	3 (76)	<b>(Pre)-03-45VO24</b>	22 <sup>1</sup> / <sub>4</sub> (565)	9 <sup>1</sup> / <sub>4</sub> (235)	13 (330)
	4 (101)	<b>(Pre)-04-45VO24</b>	22 <sup>1</sup> / <sub>4</sub> (565)	9 <sup>1</sup> / <sub>4</sub> (235)	13 (330)
	6 (152)	<b>(Pre)-06-45VO24</b>	22 <sup>1</sup> / <sub>4</sub> (565)	9 <sup>1</sup> / <sub>4</sub> (235)	13 (330)
36 (915)	3 (76)	<b>(Pre)-03-45VO36</b>	30 <sup>1</sup> / <sub>2</sub> (775)	12 <sup>5</sup> / <sub>8</sub> (321)	17 <sup>7</sup> / <sub>8</sub> (454)
	4 (101)	<b>(Pre)-04-45VO36</b>	30 <sup>1</sup> / <sub>2</sub> (775)	12 <sup>5</sup> / <sub>8</sub> (321)	17 <sup>7</sup> / <sub>8</sub> (454)
	6 (152)	<b>(Pre)-06-45VO36</b>	30 <sup>1</sup> / <sub>2</sub> (775)	12 <sup>5</sup> / <sub>8</sub> (321)	17 <sup>7</sup> / <sub>8</sub> (454)
48 (1218)	3 (76)	<b>(Pre)-03-45VO48</b>	39 (991)	16 <sup>1</sup> / <sub>8</sub> (410)	22 <sup>7</sup> / <sub>8</sub> (581)
	4 (101)	<b>(Pre)-04-45VO48</b>	39 (991)	16 <sup>1</sup> / <sub>8</sub> (410)	22 <sup>7</sup> / <sub>8</sub> (581)
	6 (152)	<b>(Pre)-06-45VO48</b>	39 (991)	16 <sup>1</sup> / <sub>8</sub> (410)	22 <sup>7</sup> / <sub>8</sub> (581)

30° Vertical Outside Bend					
12 (305)	3 (76)	<b>(Pre)-03-30VO12</b>	11 <sup>5</sup> / <sub>8</sub> (296)	3 <sup>1</sup> / <sub>8</sub> (79)	6 <sup>1</sup> / <sub>4</sub> (158)
	4 (101)	<b>(Pre)-04-30VO12</b>	11 <sup>5</sup> / <sub>8</sub> (296)	3 <sup>1</sup> / <sub>8</sub> (79)	6 <sup>1</sup> / <sub>4</sub> (158)
	6 (152)	<b>(Pre)-06-30VO12</b>	11 <sup>5</sup> / <sub>8</sub> (296)	3 <sup>1</sup> / <sub>8</sub> (79)	6 <sup>1</sup> / <sub>4</sub> (158)
24 (609)	3 (76)	<b>(Pre)-03-30VO24</b>	17 <sup>1</sup> / <sub>2</sub> (445)	4 <sup>7</sup> / <sub>8</sub> (124)	9 <sup>3</sup> / <sub>8</sub> (238)
	4 (101)	<b>(Pre)-04-30VO24</b>	17 <sup>1</sup> / <sub>2</sub> (445)	4 <sup>7</sup> / <sub>8</sub> (124)	9 <sup>3</sup> / <sub>8</sub> (238)
	6 (152)	<b>(Pre)-06-30VO24</b>	17 <sup>1</sup> / <sub>2</sub> (445)	4 <sup>7</sup> / <sub>8</sub> (124)	9 <sup>3</sup> / <sub>8</sub> (238)
36 (915)	3 (76)	<b>(Pre)-03-30VO36</b>	23 <sup>1</sup> / <sub>2</sub> (597)	6 <sup>3</sup> / <sub>8</sub> (162)	12 <sup>5</sup> / <sub>8</sub> (321)
	4 (101)	<b>(Pre)-04-30VO36</b>	23 <sup>1</sup> / <sub>2</sub> (597)	6 <sup>3</sup> / <sub>8</sub> (162)	12 <sup>5</sup> / <sub>8</sub> (321)
	6 (152)	<b>(Pre)-06-30VO36</b>	23 <sup>1</sup> / <sub>2</sub> (597)	6 <sup>3</sup> / <sub>8</sub> (162)	12 <sup>5</sup> / <sub>8</sub> (321)
48 (1218)	3 (76)	<b>(Pre)-03-30VO48</b>	29 <sup>5</sup> / <sub>8</sub> (753)	8 (203)	15 <sup>7</sup> / <sub>8</sub> (403)
	4 (101)	<b>(Pre)-04-30VO48</b>	29 <sup>5</sup> / <sub>8</sub> (753)	8 (203)	15 <sup>7</sup> / <sub>8</sub> (403)
	6 (152)	<b>(Pre)-06-30VO48</b>	29 <sup>5</sup> / <sub>8</sub> (753)	8 (203)	15 <sup>7</sup> / <sub>8</sub> (403)

(Pre) See page E-10 for catalog number prefix.

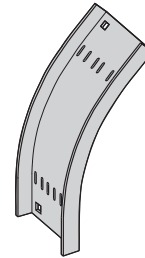

45° Vertical Outside Bend  
Ventilated Vertical Outside Bend

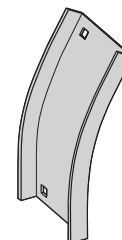
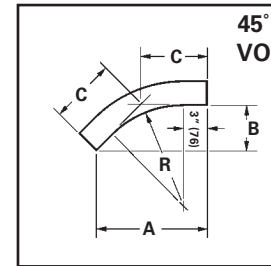

30° Vertical Outside Bend  
Non-Ventilated Vertical Outside Bend

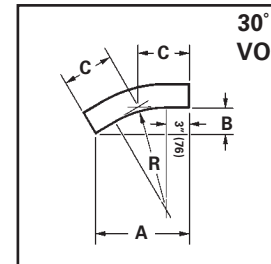

All dimensions in shaded areas are millimeters unless otherwise specified.

## Vertical Inside Bends 90°, 60° (VI)

1 splice plate with hardware included.

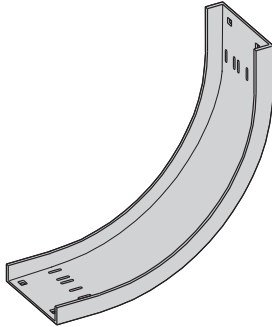

90° Vertical Inside Bend  
Ventilated Vertical Inside Bend

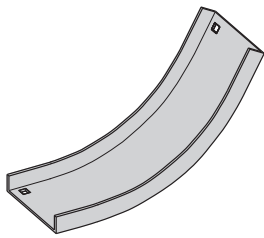
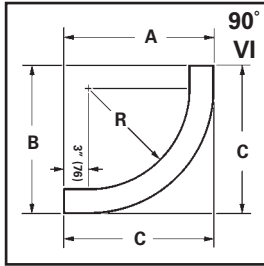

60° Vertical Inside Bend  
Non-Ventilated Vertical Inside Bend

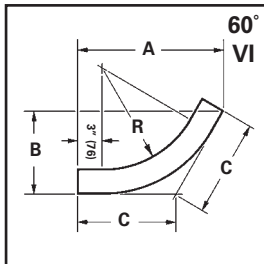

Bend Radius R	Tray Width	90° Vertical Inside Bend Dimensions			
		Catalog No.	A	B	C
in. (mm)	in. (mm)		in. (mm)	in. (mm)	in. (mm)
12 (305)	3 (76)	<b>(Pre)-03-90VI12</b>	16 <sup>1</sup> / <sub>4</sub> (413)	16 <sup>1</sup> / <sub>4</sub> (413)	16 <sup>1</sup> / <sub>4</sub> (413)
	4 (101)	<b>(Pre)-04-90VI12</b>	16 <sup>3</sup> / <sub>4</sub> (425)	16 <sup>3</sup> / <sub>4</sub> (425)	16 <sup>3</sup> / <sub>4</sub> (425)
	6 (152)	<b>(Pre)-06-90VI12</b>	16 <sup>3</sup> / <sub>4</sub> (425)	16 <sup>3</sup> / <sub>4</sub> (425)	16 <sup>3</sup> / <sub>4</sub> (425)
24 (609)	3 (76)	<b>(Pre)-03-90VI24</b>	28 <sup>1</sup> / <sub>4</sub> (718)	28 <sup>1</sup> / <sub>4</sub> (718)	28 <sup>1</sup> / <sub>4</sub> (718)
	4 (101)	<b>(Pre)-04-90VI24</b>	28 <sup>3</sup> / <sub>4</sub> (730)	28 <sup>3</sup> / <sub>4</sub> (730)	28 <sup>3</sup> / <sub>4</sub> (730)
	6 (152)	<b>(Pre)-06-90VI24</b>	28 <sup>3</sup> / <sub>4</sub> (730)	28 <sup>3</sup> / <sub>4</sub> (730)	28 <sup>3</sup> / <sub>4</sub> (730)
36 (915)	3 (76)	<b>(Pre)-03-90VI36</b>	40 <sup>1</sup> / <sub>4</sub> (1024)	40 <sup>1</sup> / <sub>4</sub> (1024)	40 <sup>1</sup> / <sub>4</sub> (1024)
	4 (101)	<b>(Pre)-04-90VI36</b>	40 <sup>3</sup> / <sub>4</sub> (1035)	40 <sup>3</sup> / <sub>4</sub> (1035)	40 <sup>3</sup> / <sub>4</sub> (1035)
	6 (152)	<b>(Pre)-06-90VI36</b>	40 <sup>3</sup> / <sub>4</sub> (1035)	40 <sup>3</sup> / <sub>4</sub> (1035)	40 <sup>3</sup> / <sub>4</sub> (1035)
48 (1218)	3 (76)	<b>(Pre)-03-90VI48</b>	52 <sup>1</sup> / <sub>4</sub> (1327)	52 <sup>1</sup> / <sub>4</sub> (1327)	52 <sup>1</sup> / <sub>4</sub> (1327)
	4 (101)	<b>(Pre)-04-90VI48</b>	52 <sup>3</sup> / <sub>4</sub> (1340)	52 <sup>3</sup> / <sub>4</sub> (1340)	52 <sup>3</sup> / <sub>4</sub> (1340)
	6 (152)	<b>(Pre)-06-90VI48</b>	52 <sup>3</sup> / <sub>4</sub> (1340)	52 <sup>3</sup> / <sub>4</sub> (1340)	52 <sup>3</sup> / <sub>4</sub> (1340)

60° Vertical Inside Bend					
Bend Radius	Tray Width	Catalog No.	A	B	C
in. (mm)	in. (mm)		in. (mm)	in. (mm)	in. (mm)
12 (305)	3 (76)	<b>(Pre)-03-60VI12</b>	16 (406)	9 <sup>1</sup> / <sub>4</sub> (235)	10 <sup>5</sup> / <sub>8</sub> (270)
	4 (101)	<b>(Pre)-04-60VI12</b>	16 <sup>1</sup> / <sub>2</sub> (419)	9 <sup>1</sup> / <sub>2</sub> (241)	11 (280)
	6 (152)	<b>(Pre)-06-60VI12</b>	16 <sup>1</sup> / <sub>2</sub> (419)	9 <sup>1</sup> / <sub>2</sub> (241)	11 (280)
24 (609)	3 (76)	<b>(Pre)-03-60VI24</b>	26 <sup>1</sup> / <sub>2</sub> (673)	15 <sup>1</sup> / <sub>4</sub> (387)	17 <sup>5</sup> / <sub>8</sub> (448)
	4 (101)	<b>(Pre)-04-60VI24</b>	26 <sup>7</sup> / <sub>8</sub> (683)	15 <sup>1</sup> / <sub>2</sub> (394)	17 <sup>7</sup> / <sub>8</sub> (454)
	6 (152)	<b>(Pre)-06-60VI24</b>	26 <sup>7</sup> / <sub>8</sub> (683)	15 <sup>1</sup> / <sub>2</sub> (394)	17 <sup>7</sup> / <sub>8</sub> (454)
36 (915)	3 (76)	<b>(Pre)-03-60VI36</b>	36 <sup>3</sup> / <sub>4</sub> (933)	21 <sup>1</sup> / <sub>4</sub> (540)	24 <sup>1</sup> / <sub>2</sub> (622)
	4 (101)	<b>(Pre)-04-60VI36</b>	37 <sup>1</sup> / <sub>8</sub> (943)	21 <sup>3</sup> / <sub>8</sub> (543)	24 <sup>3</sup> / <sub>4</sub> (629)
	6 (152)	<b>(Pre)-06-60VI36</b>	37 <sup>1</sup> / <sub>8</sub> (943)	21 <sup>3</sup> / <sub>8</sub> (543)	24 <sup>3</sup> / <sub>4</sub> (629)
48 (1218)	3 (76)	<b>(Pre)-03-60VI48</b>	47 <sup>1</sup> / <sub>8</sub> (1197)	27 <sup>1</sup> / <sub>8</sub> (689)	31 <sup>3</sup> / <sub>8</sub> (797)
	4 (101)	<b>(Pre)-04-60VI48</b>	47 <sup>5</sup> / <sub>8</sub> (1210)	27 <sup>1</sup> / <sub>2</sub> (699)	31 <sup>3</sup> / <sub>4</sub> (806)
	6 (152)	<b>(Pre)-06-60VI48</b>	47 <sup>5</sup> / <sub>8</sub> (1210)	27 <sup>1</sup> / <sub>2</sub> (699)	31 <sup>3</sup> / <sub>4</sub> (806)

(Pre) See page E-10 for catalog number prefix.

All dimensions in shaded areas are millimeters unless otherwise specified.

# Channel Cable Tray - Fittings

## Vertical Inside Bends 45°, 30° (VI)

1 splice plate with hardware included.

Bend Radius R	Tray Width	45° Vertical Inside Bend Dimensions			
		Catalog No.	A	B	C
in. (mm)	in. (mm)		in. (mm)	in. (mm)	in. (mm)
12 (305)	3 (76)	<b>(Pre)-03-45VI12</b>	14 <sup>1</sup> / <sub>2</sub> (368)	6 (152)	8 <sup>1</sup> / <sub>2</sub> (216)
	4 (101)	<b>(Pre)-04-45VI12</b>	14 <sup>7</sup> / <sub>8</sub> (373)	6 <sup>1</sup> / <sub>8</sub> (156)	8 <sup>3</sup> / <sub>4</sub> (222)
	6 (152)	<b>(Pre)-06-45VI12</b>	14 <sup>7</sup> / <sub>8</sub> (373)	6 <sup>1</sup> / <sub>8</sub> (156)	8 <sup>3</sup> / <sub>4</sub> (222)
24 (609)	3 (76)	<b>(Pre)-03-45VI24</b>	23 (584)	9 <sup>1</sup> / <sub>2</sub> (241)	13 <sup>1</sup> / <sub>2</sub> (343)
	4 (101)	<b>(Pre)-04-45VI24</b>	23 <sup>1</sup> / <sub>4</sub> (591)	9 <sup>5</sup> / <sub>8</sub> (245)	13 <sup>5</sup> / <sub>8</sub> (346)
	6 (152)	<b>(Pre)-06-45VI24</b>	23 <sup>1</sup> / <sub>4</sub> (591)	9 <sup>5</sup> / <sub>8</sub> (245)	13 <sup>5</sup> / <sub>8</sub> (346)
36 (915)	3 (76)	<b>(Pre)-03-45VI36</b>	31 <sup>3</sup> / <sub>8</sub> (797)	13 (330)	18 <sup>3</sup> / <sub>8</sub> (467)
	4 (101)	<b>(Pre)-04-45VI36</b>	31 <sup>3</sup> / <sub>4</sub> (806)	13 <sup>1</sup> / <sub>8</sub> (334)	18 <sup>5</sup> / <sub>8</sub> (473)
	6 (152)	<b>(Pre)-06-45VI36</b>	31 <sup>3</sup> / <sub>4</sub> (806)	13 <sup>1</sup> / <sub>8</sub> (334)	18 <sup>5</sup> / <sub>8</sub> (473)
48 (1218)	3 (76)	<b>(Pre)-03-45VI48</b>	39 <sup>7</sup> / <sub>8</sub> (1013)	16 <sup>1</sup> / <sub>2</sub> (419)	23 <sup>3</sup> / <sub>8</sub> (594)
	4 (101)	<b>(Pre)-04-45VI48</b>	40 <sup>3</sup> / <sub>8</sub> (1026)	16 <sup>3</sup> / <sub>4</sub> (425)	23 <sup>5</sup> / <sub>8</sub> (600)
	6 (152)	<b>(Pre)-06-45VI48</b>	40 <sup>3</sup> / <sub>8</sub> (1026)	16 <sup>3</sup> / <sub>4</sub> (425)	23 <sup>5</sup> / <sub>8</sub> (600)

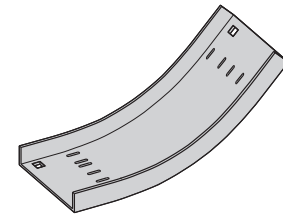

45° Vertical Inside Bend  
Ventilated Vertical Inside Bend

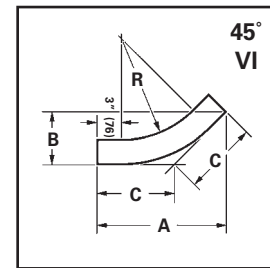

30° Vertical Inside Bend					
Bend Radius R	Tray Width	30° Vertical Inside Bend Dimensions			
		Catalog No.	A	B	C
in. (mm)	in. (mm)		in. (mm)	in. (mm)	in. (mm)
12 (305)	3 (76)	<b>(Pre)-03-30VI12</b>	12 <sup>1</sup> / <sub>8</sub> (308)	3 <sup>1</sup> / <sub>8</sub> (83)	6 <sup>1</sup> / <sub>2</sub> (165)
	4 (101)	<b>(Pre)-04-30VI12</b>	12 <sup>3</sup> / <sub>8</sub> (314)	3 <sup>3</sup> / <sub>8</sub> (86)	6 <sup>5</sup> / <sub>8</sub> (163)
	6 (152)	<b>(Pre)-06-30VI12</b>	12 <sup>3</sup> / <sub>8</sub> (314)	3 <sup>3</sup> / <sub>8</sub> (86)	6 <sup>5</sup> / <sub>8</sub> (163)
24 (609)	3 (76)	<b>(Pre)-03-30VI24</b>	18 <sup>1</sup> / <sub>8</sub> (461)	4 <sup>3</sup> / <sub>4</sub> (121)	9 <sup>3</sup> / <sub>4</sub> (248)
	4 (101)	<b>(Pre)-04-30VI24</b>	18 <sup>3</sup> / <sub>8</sub> (467)	4 <sup>7</sup> / <sub>8</sub> (124)	9 <sup>7</sup> / <sub>8</sub> (251)
	6 (152)	<b>(Pre)-06-30VI24</b>	18 <sup>3</sup> / <sub>8</sub> (467)	4 <sup>7</sup> / <sub>8</sub> (124)	9 <sup>7</sup> / <sub>8</sub> (251)
36 (915)	3 (76)	<b>(Pre)-03-30VI36</b>	24 <sup>1</sup> / <sub>4</sub> (616)	6 <sup>1</sup> / <sub>2</sub> (165)	13 (330)
	4 (101)	<b>(Pre)-04-30VI36</b>	24 <sup>1</sup> / <sub>2</sub> (622)	6 <sup>5</sup> / <sub>8</sub> (168)	13 <sup>1</sup> / <sub>8</sub> (334)
	6 (152)	<b>(Pre)-06-30VI36</b>	24 <sup>1</sup> / <sub>2</sub> (622)	6 <sup>5</sup> / <sub>8</sub> (168)	13 <sup>1</sup> / <sub>8</sub> (334)
48 (1218)	3 (76)	<b>(Pre)-03-30VI48</b>	30 <sup>3</sup> / <sub>8</sub> (772)	8 <sup>1</sup> / <sub>8</sub> (207)	16 <sup>1</sup> / <sub>4</sub> (413)
	4 (101)	<b>(Pre)-04-30VI48</b>	30 <sup>5</sup> / <sub>8</sub> (778)	8 <sup>1</sup> / <sub>4</sub> (210)	16 <sup>3</sup> / <sub>8</sub> (416)
	6 (152)	<b>(Pre)-06-30VI48</b>	30 <sup>5</sup> / <sub>8</sub> (778)	8 <sup>1</sup> / <sub>4</sub> (210)	16 <sup>3</sup> / <sub>8</sub> (416)

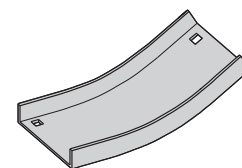

30° Vertical Inside Bend  
Non-Ventilated Vertical Inside Bend

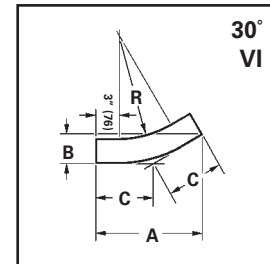

(Pre) See page E-10 for catalog number prefix.

All dimensions in shaded areas are millimeters unless otherwise specified.