

NEER™ Service Entrance Flashings

NEC/CEC:
Rated for Ordinary Locations

NC: No Caulk, Galvanized Steel

Applications

- These are used to provide a watertight connection between the roof line and service masts or ventilation pipes.



Standard Material

- NC and 1000: galvanized steel
- 1000-N: neoprene

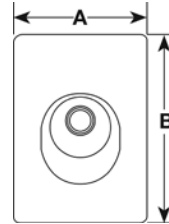
Illustrated Dimensions



COMMERCIAL AND INDUSTRIAL FITTINGS: SERVICE ENTRANCE FITTINGS

	Trade Size (Inches)	Dimensions in Millimeters (Inches)		Catalog Number
		A	B	
NC: No Caulk, Galvanized				
	1-1/4 - 1-1/2	222.3 (8.75)	317.5 (12.50)	NC-1069
	2	225.6 (8.88)	317.5 (12.50)	NC-1070
	2-1/2 - 3-1/2	273.1 (10.75)	368.3 (14.50)	NC-1071
1000: Galvanized with Collar				
	2	273.1 (10.75)	368.3 (14.50)	1070
	2-1/2	273.1 (10.75)	368.3 (14.50)	1071
1000-N: All-Neoprene				
	1-1/4 - 1-1/2	228.6 (9.00)	285.8 (11.25)	1069-N
	2	228.6 (9.00)	292.1 (11.50)	1070-N
	2-1/2 - 3-1/2	228.6 (9.00)	292.1 (11.50)	1071-N
	3	254.0 (10.00)	342.9 (13.50)	1072-N