

Asset Tracking Materials

www.BradyID.com



3" Core Asset Tracking Materials:

B-434 Polyester Material

Color: Silver Metallic Finish: Gloss

Metallized polyester with a glossy finish and adhesive (2 mils) for rough surface applications. Withstands numerous solvents while maintaining excellent image quality.

Performance Attributes:

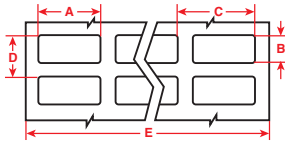

Figure 1

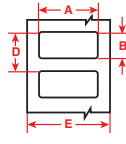

Figure 2

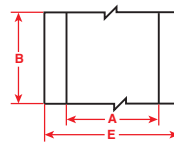

Figure 3



Diagram	Catalog #	Material	Color	Label Width A Inch (mm)	Label Height B Inch (mm)	Horiz. Repeat C Inch (mm)	Vert. Repeat D Inch (mm)	Web Width E Inch (mm)	Labels Per Row	Labels Per Pkg	Rec. Ribbon
Fig. 1	THT-5-434-10	Polyester	Silver	1.000 (25.4)	0.500 (12.7)	1.075 (27.3)	0.600 (15.2)	3.350 (85.1)	3	10,000	R6007
Fig. 1	THT-37-434-10	Polyester	Silver	1.500 (38.1)	0.500 (12.7)	1.650 (41.9)	0.600 (15.2)	3.350 (85.1)	2	10,000	R6007
Fig. 1	THT-6-434-10	Polyester	Silver	1.500 (38.1)	0.750 (19.1)	1.650 (41.9)	0.875 (22.2)	3.350 (85.1)	2	10,000	R6007
Fig. 2	THT-17-434-3	Polyester	Silver	2.000 (50.8)	1.000 (25.4)	-	1.125 (28.6)	2.200 (55.9)	1	3,000	R6000
Fig. 2	THT-18-434-3	Polyester	Silver	3.000 (76.2)	1.000 (25.4)	-	1.125 (28.6)	3.200 (81.3)	1	3,000	R6002
Fig. 2	THT-19-434-1	Polyester	Silver	3.000 (76.2)	2.000 (50.8)	-	2.125 (54.0)	3.200 (81.3)	1	1,000	R6002
Fig. 3	THT-21-434	Polyester	Silver	3.000 (76.2)	300 ft. (91.4 m)	-	300 ft. (91.4 m)	3.200 (81.3)	1	1 Roll Cont.	R6002
Fig. 2	THT-55-434-1	Polyester	Silver	4.000 (101.6)	2.000 (50.8)	-	2.125 (54.0)	4.200 (106.7)	1	1,000	R6007



3" Core Asset Tracking Materials:

B-435 Polyester Material

Color: Silver Metallic Finish: Gloss

Printable metallized polyester withstands numerous solvents and variable temperatures. Ideal for serial and rating plate applications with name-plate quality and a metal looking finish.

Performance Attributes:

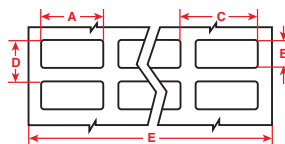

Figure 1

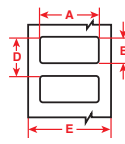

Figure 2



Diagram	Catalog #	Material	Color	Label Width A Inch (mm)	Label Height B Inch (mm)	Horiz. Repeat C Inch (mm)	Vert. Repeat D Inch (mm)	Web Width E Inch (mm)	Labels Per Row	Labels Per Pkg	Rec. Ribbon
Fig. 1	THT-1-435-10	Polyester	Silver	0.750 (19.1)	0.250 (6.4)	0.800 (20.3)	0.350 (8.9)	3.350 (85.1)	4	10,000	R6007
Fig. 1	THT-5-435-10	Polyester	Silver	1.000 (25.4)	0.500 (12.7)	1.075 (27.3)	0.600 (15.2)	3.350 (85.1)	3	10,000	R6007
Fig. 2	THT-17-435-3	Polyester	Silver	2.000 (50.8)	1.000 (25.4)	-	1.125 (28.6)	2.200 (55.9)	1	3,000	R6000
Fig. 2	THT-18-435-3	Polyester	Silver	3.000 (76.2)	1.000 (25.4)	-	1.125 (28.6)	3.200 (81.3)	1	3,000	R6002
Fig. 2	THT-19-435-1	Polyester	Silver	3.000 (76.2)	2.000 (50.8)	-	2.125 (54.0)	3.200 (81.3)	1	1,000	R6002
Fig. 2	THT-184-435-1	Polyester	Silver	3.000 (76.2)	3.000 (76.2)	-	3.125 (79.38)	3.200 (81.28)	1	1,000	R6000
Fig. 2	THT-20-435-1	Polyester	Silver	3.000 (76.2)	5.000 (127.0)	-	5.125 (130.18)	3.200 (81.28)	1	1,000	R6000
Fig. 2	THT-55-435-1	Polyester	Silver	4.000 (101.6)	2.000 (50.8)	-	2.125 (54.0)	4.200 (106.7)	1	1,000	R6007
Fig. 2	THT-25-435-1	Polyester	Silver	4.000 (101.6)	6.000 (152.4)	-	6.125 (155.58)	4.200 (106.68)	1	1,000	R6000



Did You Know? www.BradyID.com

Visit BradyID.com for online ordering and instant access to:

- Product Info
- Product Demos
- Custom Orders
- Whitepapers
- Webinars
- And More!



View the Material Brands & Attributes Guide on page 4.
Benchtop Printer Ribbons on page 184.
Full Material Properties on page 187.