

# Beam Clamps

## Type IS

**Use:**  
Provides support for conduit hanging systems.

**Material:**  
Malleable Iron clamp  
Steel Screw, case hardened

**Finish:**  
Clamp - Hot Dip Galvanized  
Screw - Zinc Electroplated

Catalog Number	A Tapped Holes	B Jaw Opening	Dimensions in Inches			Max. Load (lbs.)
			C	D	E	
IS-500	¼ - 20	15/16	7/8	1 1/8	1	335
IS-509	10 - 24	15/16	7/8	1 1/8	1	335
IS-501	5/16 - 18	15/16	1 1/8	1 13/16	1 1/2	525
IS-502	3/8 - 16	1	1 3/8	2 1/16	2	750
IS-503	1/2 - 13	1 1/8	1 11/16	2 1/4	2 5/8	900

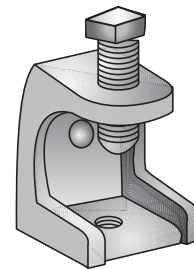

Type IS

