

# BC Beam Clamp – BC

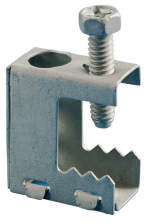

- Easy installation to beam flanges

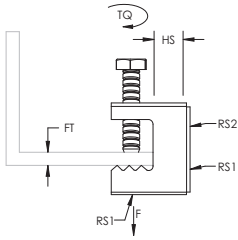

Part Number	BC
Material	Spring Steel
Finish	CADDY ARMOUR
Rod Size 1 (RS1)	1/4"
Rod Size 2 (RS2)	#10
Hole Size (HS)	7/16"
Flange Thickness (FT)	1/2" Max
Torque (TQ)	20 in lb
Static Load (F)	100 lb
Certifications	cULus
Standard Packaging Quantity	100 pc
UPC	78285619100

Setscrew must be tightened and torqued onto the sloped side of the I-beam.

UL, UR, cUL, cUR, cULus and cURus are registered certification marks of UL LLC.

#### WARNING

Pentair products shall be installed and used only as indicated in Pentair's product instruction sheets and training materials. Instruction sheets are available at [erico.pentair.com](http://erico.pentair.com) and from your Pentair customer service representative. Improper installation, misuse, misapplication or other failure to completely follow Pentair's instructions and warnings may cause product malfunction, property damage, serious bodily injury and death and/or void your warranty.

© 2018 Pentair All rights reserved  
 Pentair, CADDY, CADWELD, CRITEC, ERICO, ERIFLEX, ERITECH and LENTON are owned by Pentair or its global affiliates.  
 All other trademarks are the property of their respective owners. Pentair reserves the right to change specifications without prior notice.

