

Coaxial Cable Straps

- Use with round cable such as CATV/VCR, RG-5, RG-6 and phone cables or with plastic and metal tubing
- Smooth plastic saddle prevents damage to cable
- Zinc-plated nails resist rust and corrosion



Description	Nail Type	Qty./Package	Cat. No.
1/4 in. White	Standard	25/Clamshell	772808
		100/Clamshell	772809
		250/Jar	BPCXSW-JR
1/4 in. Black	Standard	25/Clamshell	772806
		100/Clamshell	772807
		250/Jar	BPCXSB-JR
	Roofing	25/Clamshell	772891
		200/Jar	BPCSRB-JR
	Masonry	25/Clamshell	772890
200/Jar		BPCXMBJR	
Double 1/4" Black	Standard	200/Jar	BPDCXSBJR
7/16 in. White	Standard	50/Bag	BPS4-50

Plastic Insulated Service Entrance Straps

- Use with service entrance cable and conduit
- Smooth plastic saddle prevents damage to cable
- Zinc-plated nails resist rust and corrosion

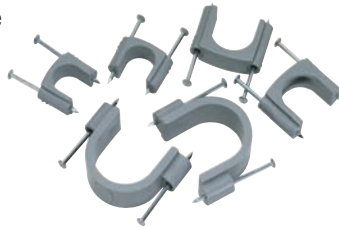

Description	Qty./Package	Cat. No.
#6 SER & 1/2 in. EMT	50/Bag	BSER6-50
#6 & #8 SEU	50/Bag	BSEU6-50
#2 SER & 3/4 in. EMT	25/Bag	BSER2-25
#2 SEU	25/Bag	BSEU2-25
4/0 SER	5/Bag	BSER4/0-5
4/0 SEU	5/Bag	BSEU4/0-5

Data Cable Staples

- Secures Category 3, 5 and other 4-pair twisted wire
- Blue plastic saddle prevents damage to cable
- Zinc-plated nails resist rust and corrosion



Description	Nail Type	Qty./Package	Cat. No.
Data Staple	Standard	25/Clamshell	772880
	Standard	250/Jar	BPDATAS-JR
	Masonry	250/Clamshell	772881

Sound Straps

- Use with smaller insulated wire and cord applications such as lamps, thermostats, telephones and sound systems
- Smooth plastic saddle prevents damage to wires
- Zinc-plated nails resist rust and corrosion



Description	Nail Type	Qty./Package	Cat. No.
3/16 in. White	Standard	25/Clamshell	772804
		100/Clamshell	772805
		250/Jar	BPLVSW-JR
3/16 in. Black	Standard	25/Clamshell	772810
		250/Jar	BPLVSB-JR
3/16 in. Tan	Standard	25/Clamshell	772881
3/16 in. White	Masonry	25/Clamshell	772813

Carbon Steel Service Entrance Staples

- Use with service entrance cable and conduit
- High-grade carbon steel construction
- Sharp-point legs drive straight without splitting wood
- Resist rust and corrosion



Description	Qty./Package	Cat. No.
1-5/16 in. x 3/4 in.	100/Box	BMSE150-1
1-1/2 in. x 1-1/16 in.	100/Box	BMSE175-1