

POWER-STRUT® Part No. Std Wt./ List Price
& Length Fin. Qty 100 per 100 pcs

PS 821

Eight Hole Double Angle Connector

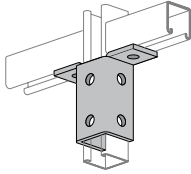

PS 821	EG	10	150	\$1862.37
PS 821	GR	10	150	\$1862.37

PS 822

Double 45° Connector

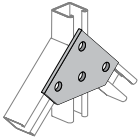

PS 822	EG	25	112	\$1168.59
PS 822	GR	25	112	\$1168.59

PS 825 RH/LH

Pipe Axle Support

Specify RH or LH (1 1/2" Max. Pipe)

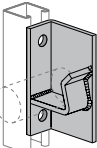

PS 825 RH	EG	10	220	\$2542.58
PS 825 RH	GR	10	220	\$2542.58
PS 825 LH	EG	10	220	\$2542.58
PS 825 LH	GR	10	220	\$2542.58

PS 826

Double Pipe Axle Support (1 1/2" Max. Pipe)

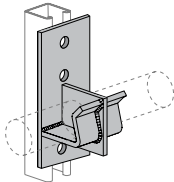

PS 826	EG	5	310	\$3988.80
PS 826	GR	5	310	\$3988.80

PS 838 RH/LH

6" Thru 30" Shelf Bracket

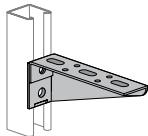

PS 838 6 RH	EG	25	58	\$1040.28
PS 838 6 RH	GR	25	58	\$1040.28
PS 838 8 RH	EG	25	83	\$1154.45
PS 838 8 RH	GR	25	83	\$1154.45
PS 838 10 RH	EG	25	114	\$1215.01
PS 838 10 RH	GR	25	114	\$1215.01
PS 838 12 RH	EG	25	149	\$1626.39
PS 838 12 RH	GR	25	149	\$1626.39
PS 838 14 RH	EG	25	174	\$1954.82
PS 838 14 RH	GR	25	174	\$1954.82
PS 838 16 RH	EG	20	225	\$2204.64
PS 838 16 RH	GR	20	225	\$2204.64
PS 838 18 RH	EG	20	255	\$2695.18
PS 838 18 RH	GR	20	255	\$2695.18
PS 838 20 RH	EG	20	295	\$3231.07
PS 838 20 RH	GR	20	295	\$3231.07
PS 838 22 RH	EG	Bulk	361	\$3807.00
PS 838 22 RH	GR	Bulk	361	\$3807.00
PS 838 24 RH	EG	Bulk	396	\$4065.79
PS 838 24 RH	GR	Bulk	396	\$4065.79
PS 838 26 RH	EG	Bulk	456	\$4302.03
PS 838 26 RH	GR	Bulk	456	\$4302.03

POWER-STRUT® Part No. Std Wt./ List Price
& Length Fin. Qty 100 per 100 pcs

PS 838 28 RH	EG	Bulk	479	\$4570.31
PS 838 28 RH	GR	Bulk	479	\$4570.31
PS 838 30 RH	EG	Bulk	544	\$4856.22
PS 838 30 RH	GR	Bulk	544	\$4856.22
PS 838 6 LH	EG	25	58	\$1040.28
PS 838 6 LH	GR	25	58	\$1040.28
PS 838 8 LH	EG	25	83	\$1154.45
PS 838 8 LH	GR	25	83	\$1154.45
PS 838 10 LH	EG	25	114	\$1215.01
PS 838 10 LH	GR	25	114	\$1215.01
PS 838 12 LH	EG	25	149	\$1626.39
PS 838 12 LH	GR	25	149	\$1626.39
PS 838 14 LH	EG	25	174	\$1954.82
PS 838 14 LH	GR	25	174	\$1954.82
PS 838 16 LH	EG	20	225	\$2204.64
PS 838 16 LH	GR	20	225	\$2204.64
PS 838 18 LH	EG	20	255	\$2695.18
PS 838 18 LH	GR	20	255	\$2695.18
PS 838 20 LH	EG	20	295	\$3231.07
PS 838 20 LH	GR	20	295	\$3231.07
PS 838 22 LH	EG	Bulk	361	\$3807.00
PS 838 22 LH	GR	Bulk	361	\$3807.00
PS 838 24 LH	EG	Bulk	396	\$4065.79
PS 838 24 LH	GR	Bulk	396	\$4065.79
PS 838 26 LH	EG	Bulk	456	\$4302.03
PS 838 26 LH	GR	Bulk	456	\$4302.03
PS 838 28 LH	EG	Bulk	479	\$4570.31
PS 838 28 LH	GR	Bulk	479	\$4570.31
PS 838 30 LH	EG	Bulk	544	\$4856.22
PS 838 30 LH	GR	Bulk	544	\$4856.22

PS 854

Flat Connector

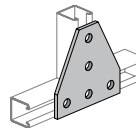

PS 854	EG	25	148	\$1912.33
PS 854	GR	25	148	\$1912.33

PS 855

Angular "I" Beam Clamp

PS 855 1-Use With PS 200; PS 855 2-Use With PS 500

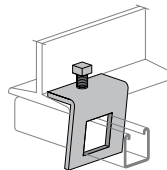

PS 855 1	EG	25	107	\$802.27
PS 855 1	GR	25	107	\$802.27
PS 855 2	EG	25	98	\$973.34
PS 855 2	GR	25	98	\$973.34

PS 858

Heavy Duty Suspension Rod Beam Clamps

Includes Set Screw (Safety Anchor Strap PS 871

To Be Ordered Separately According To Length Required)

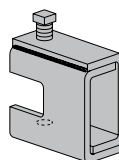

PS 858 1/4	EG	1/4"x20 Rod	10	67	\$1587.29
PS 858 5/16	EG	5/16"x18 Rod	10	67	\$1758.37
PS 858 3/8	EG	3/8"x16 Rod	10	100	\$1679.35
PS 858 1/2	EG	1/2"x13 Rod	10	130	\$1854.90
PS 858 5/8	EG	5/8"x11 Rod	10	160	\$2893.55
PS 858 3/4	EG	3/4"x10 Rod	10	160	\$3510.34