

Combination Devices

Providing either 2 or 3 devices in a single-gang box with decorator or traditional styling, our broad line of combination devices encompasses switches, receptacles, pilot lights and nightlights. Bathrooms, kitchens, basements and hallways are all locations that often require or can benefit from the space savings and convenience of combination devices.

Combination Device Families

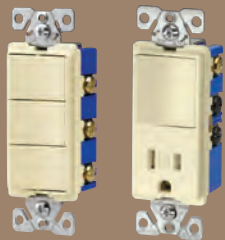

Decorator
Heavy Duty Grade
Combination Devices

B-15

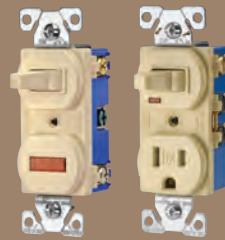

Traditional Style
Heavy Duty Grade
Combination Devices

B-16

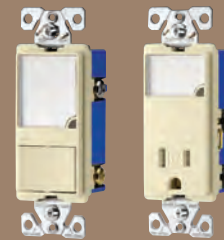

Dimmable Nightlight
Heavy Duty Grade
Combination Devices

B-18

Combination Device Colors

Almond
(A)

Black
(BK)

Brown
(B)

Ivory
(V)

Light Almond
(LA)

White
(W)

- 1 Convenient patented built-in wire stripper speeds installation
- 2 Steel mounting strap is zinc-plated for added corrosion resistance
- 3 USB Receptacles allow for quick and convenient charging of most electronic components
- 4 Nightlight models feature dimmable LED lamps



Specific Combination Device Solutions for Today's Needs



Light & Motor Control
 Combination switches are horsepower rated to carry motor loads such as bathroom fans and garbage disposals on the same or separate circuits.



Shown: 7728

See pages: B-15



LED Nightlight Combinations
 Ideal for bathrooms, hallways, stairs and landings, flush-mount LED nightlight combination devices provide added safety and comfort along with switch or receptacle functionality.



Shown: TR7735

See page: B-18



USB Charging
 Perfect for quickly and easily charging most electronic components without powered computers or bulky adapters.



Shown: TR7740

See page: B-14

Dimmable LED Nightlight Heavy Duty Grade Combination Devices

15A, 120V/AC Single-Pole Switch 15A, 125V/AC & 20A, 125V/AC Receptacles
120V Nightlight

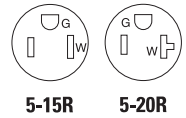

7738



TR7735



7737

Features

- Light sensor turns the nightlight ON when ambient light is low, and OFF when ambient light is high
- Nightlights are dimmable to desired light level.
- Long-lasting energy efficient LED bulbs are rated for 50,000 hours lamp life
- Nightlight features full dimming as well as 3 preset levels to easily match light levels on devices mounted in series
- Nightlights use 3 LED lamps that consume a maximum of 1 watt of energy
- Convenient patented built-in wire stripper speeds installation
- Combination Nightlight/Receptacle (TR7735 & TR7736) features UL listed Tamper Resistant shutters that prevent the insertion of foreign objects
- Automatic grounding system eliminates the need for bonding jumper in grounded metal enclosure and provides redundant measure of ground continuity where a jumper is used
- Terminal screws are backed out and ready for wiring to enhance ease of installation
- Devices mounted in series can be controlled by an external switch in guide light mode



LED Nightlight Combination with Switch



Rating		Description	Color Suffix	Catalog No.
W	V/AC A			
1	120 15	One Single-Pole Switch with Nightlight, Back & Side Wire	A, BK, LA, V, W	□ 7738__

cULus Listed to UL20, file no. E18704; NOM certified

LED Nightlight Combination with Receptacle



Rating		Description	Color Suffix	Catalog No.
W	V/AC A			
1	120	Nightlight with One Tamper Resistant NEMA 5-15R 2-Pole	A, BK, LA, V, W	□ TR7735__
	125 15	3-Wire Receptacle, Back & Side Wire		

cULus Listed to UL498, file no. E15058; NOM certified

LED Nightlight Combination with Receptacle



Rating		Description	Color Suffix	Catalog No.
W	V/AC A			
1	120	Nightlight and One Tamper Resistant NEM 5-20R 2-Pole	A, BK, LA, V, W	□ TR7736__
	125 20	3-Wire Receptacle, Back & Side Wire		

cULus Listed to UL498, file no. E15058; NOM certified

Full LED Nightlight



Rating		Description	Color Suffix	Catalog No.
W	V/AC			
1	120	Full Hallway Nightlight, Back & Side Wire	A, BK, LA, V, W	□ 7737__

cULus Listed to UL1598, file no. E334295; NOM certified

Color Ordering Information:

For ordering devices, include Catalog No. followed by the Color Suffix: A (Almond), BK (Black), LA (Light Almond), V (Ivory), W (White)



Dimensional Information: B-68 **Specification Information:** Please visit www.cooperwiringdevices.com. Specifications and availability are subject to change without notice.

Switches

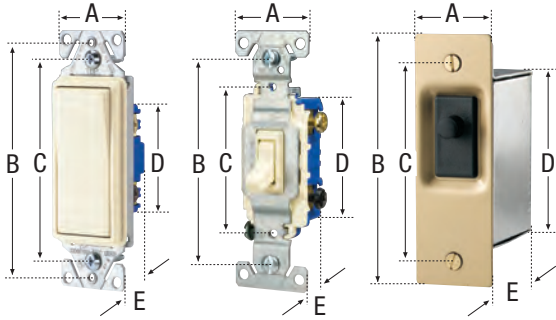

Family	A	B	C	D	E
Decorator Standard Grade, Single-Pole & 3-Way	1.44" (36.6mm)	3.81" (96.8mm)	3.28" (83.3mm)	2.74" (69.6mm)	0.97" (24.6mm)
Decorator Standard Grade, 4-Way	1.44" (36.6mm)	3.81" (96.8mm)	3.28" (83.3mm)	2.60" (66.1mm)	1.18" (30.0mm)
Heavy Duty Grade Toggle	1.31" (33.3mm)	3.28" (83.3mm)	2.38" (60.5mm)	2.00" (50.8mm)	1.05" (26.7mm)
Standard Grade Toggle	1.31" (33.3mm)	3.28" (83.3mm)	2.38" (60.5mm)	2.13" (54.1mm)	0.88" (22.4mm)
Standard Grade Toggle, Less Ears	0.75" (19.1mm)	3.28" (83.3mm)	2.38" (60.5mm)	2.13" (54.1mm)	0.88" (22.4mm)
CO/ALR Standard Grade Toggle	1.31" (33.3mm)	3.28" (83.3mm)	2.38" (60.5mm)	2.13" (54.1mm)	0.88" (22.4mm)
Door Operated Canopy Switch Assembly	1.25" (31.8mm)	3.94" (100.1mm)	3.13" (79.5mm)	2.63" (66.8mm)	1.25" (31.8mm)

Circuit Control Switches

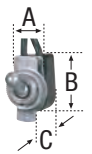

Cat. No.	A	B	C
452	0.50" (12.7mm)	0.88" (22.4mm)	0.53" (13.5mm)

Feed-Through Cord Switches

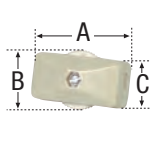

Cat. Nos.	A	B	C
410	1.35" (34.5mm)	0.91" (23.1mm)	0.55" (14.0mm)
933	2.49" (63.4mm)	1.47" (36.7mm)	1.25" (31.6mm)

Combination Devices

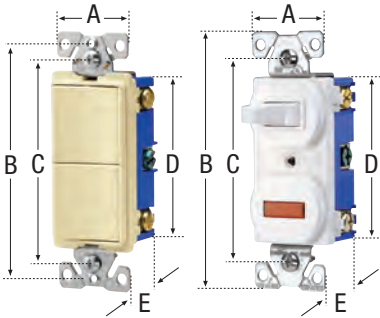

Family	A	B	C	D	E
Decorator Combination	1.30" (33.0mm)	3.81" (96.8mm)	3.28" (83.3mm)	2.65" (67.3mm)	1.08" (27.4mm)
Traditional Combination	1.30" (33.0mm)	4.19" (106.4mm)	3.28" (83.3mm)	2.65" (67.3mm)	1.08" (27.4mm)
Nightlight Combination	1.30" (33.0mm)	3.81" (96.8mm)	3.28" (83.3mm)	2.65" (67.3mm)	1.08" (27.4mm)

Duplex Receptacle

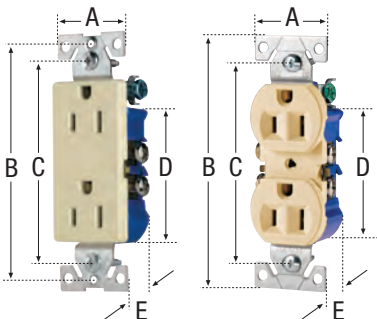

Family or Cat. No.	A	B	C	D	E
Heavy Duty Grade Tamper Resistant	1.24" (31.5mm)	4.00" (101.6mm)	3.23" (82.0mm)	2.63" (66.8mm)	1.04" (26.4mm)
Decorator Standard Grade	1.30" (33.0mm)	3.81" (96.8mm)	3.28" (83.3mm)	2.12" (53.8mm)	0.69" (17.5mm)
Standard Grade, except 298	1.31" (33.3mm)	4.19" (106.4mm)	3.28" (83.3mm)	2.63" (66.8mm)	0.69" (17.5mm)
298	1.31" (33.3mm)	4.19" (106.4mm)	3.28" (83.3mm)	2.63" (66.8mm)	0.74" (18.8mm)
CO/ALR Standard Grade	1.38" (35.1mm)	4.06" (103.1mm)	3.28" (83.3mm)	2.61" (66.3mm)	0.71" (18.0mm)