

# SUPERBAY BI SERIES

14" ALUMINUM  
REFLECTOR

Cat. #		Approvals
Job	Type	



## APPLICATIONS

- Narrow, medium and wide lighting distributions for applications flexibility.

## SPECIFICATIONS

- Anodal<sup>®</sup> finished 14" diameter spun aluminum reflector.
- Field adjustable brackets provide narrow, medium and wide lighting distributions.
- Rugged, two-piece, die cast aluminum ballast housing with corrosion-resistant Lektrocote<sup>®</sup> white finish.
- Unit Pack available, see table below.

## LISTINGS

- Up to 55°C ambient, suitable for damp location, minimum 90°C supply conductors.

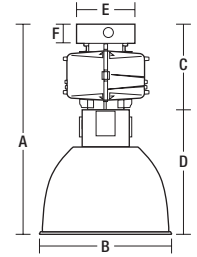

	A	B	C	D	E	F
<b>SLICK-ON<sup>®</sup></b>	22 <sup>3</sup> / <sub>16</sub> "-24 <sup>7</sup> / <sub>16</sub> "	14 <sup>1</sup> / <sub>4</sub> "	9 <sup>1</sup> / <sub>2</sub> "	9 <sup>7</sup> / <sub>16</sub> "	9 <sup>1</sup> / <sub>2</sub> "	2"
	564-621 mm	362 mm	241 mm	240 mm	241 mm	51 mm
<b>QUICK-ON<sup>®</sup></b>	21 <sup>5</sup> / <sub>16</sub> "-23 <sup>9</sup> / <sub>16</sub> "	14 <sup>1</sup> / <sub>4</sub> "	8 <sup>5</sup> / <sub>8</sub> "	9 <sup>7</sup> / <sub>16</sub> "	9 <sup>7</sup> / <sub>16</sub> "	1 <sup>1</sup> / <sub>8</sub> "
	541-598 mm	362 mm	219 mm	240 mm	240 mm	29 mm



## ORDERING INFORMATION

ORDERING EXAMPLE: BL-400P8-BI-WH

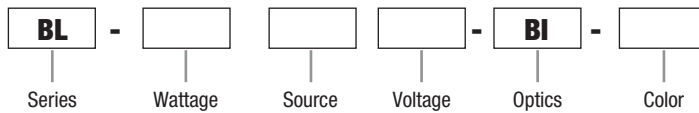

### SERIES

**BL** Superbay Series

### SOURCE

**S** High Pressure Sodium  
**P** Pulse Start Metal Halide

### VOLTAGE

**5** 480V  
**8** Quad-Tap<sup>®</sup> - 120/208/240/277V

### OPTICS

**BI** 14" Spun Aluminum High Bay Reflector with uplight

### WATTAGE

**175** 175 watt Pulse Start MH only  
**250** 250 watt MH, Pulse Start MH or HPS  
**320** 320 watt Pulse Start MH only  
**400** 400 watt Pulse Start MH or HPS

### COLOR

**WH** White (standard)  
**GR** Gray (optional)

NOTE: Energy Saving Linear Reactor Pulse Start ballast available, consult factory (277V only).  
NOTE: Bottom enclosures are required unless lamps designated as "suitable for open use" are used.  
NOTE: Options must be added as suffix to Catalog Number. Accessories must be ordered separately.

## ACCESSORY

Order separately

### BOTTOM ENCLOSURE

**BL-LR-14** Bottom Enclosure

## BI UNIT PACKS

MATERIAL	MATERIAL DESCRIPTION	WATTAGE	VOLTAGE	LAMP BASE
<b>METAL HALIDE PULSE START</b>				
BL400P8BCXUPL	BL-400P8-BC-WH-EX-UPL	400	Quad-Tap	Exclusionary
BL400P8BCWHUPL	BL-400P8-BC-WH-UPL	400	Quad-Tap	Mogul

## ORDERING INFORMATION

### OPTIONS FOR SUPERBAY SERIES

Factory installed — order with fixture by adding suffix.

PLUGS ARE TWIST-LOCK® TYPE AS MANUFACTURED BY HUBBELL WIRING DEVICES.

Suffix	Description
<b>-CFB</b>	Charcoal filter breather
<b>-C4HL</b>	4' Cord, Hook/Loop w/ Quick-On® Hanger - SO cord wired thru hook
<b>-C6HL</b>	6' Cord, Hook/Loop w/ Quick-On® Hanger - SO cord wired thru hook
<b>-C8HL</b>	8' Cord, Hook/Loop w/ Quick-On® Hanger - SO cord wired thru hook
<b>-C10HL</b>	10' Cord, Hook/Loop w/ Quick-On® Hanger - SO cord wired thru hook
<b>-C12HL</b>	12' Cord, Hook/Loop w/ Quick-On® Hanger - SO cord wired thru hook

CORD, HOOK/LOOP & 20A PLUG W/ QUICK-ON® HANGER -  
SO CORD W/ PLUG WIRED THRU HOOK

LENGTH	X=	120V	208V	240V	277V	480V	347V
<b>-C4HLP (X)</b>	4'	1	2	3	4	5	C
<b>-C6HLP (X)</b>	6'	1	2	3	4	5	C
<b>-C8HLP (X)</b>	8'	1	2	3	4	5	C
<b>-C10HLP (X)</b>	10'	1	2	3	4	5	C
<b>-C12HLP (X)</b>	12'	1	2	3	4	5	C

CORD, HOOK/LOOP & 15A PLUG W/ QUICK-ON® HANGER -  
SO CORD W/ PLUG WIRED THRU HOOK

LENGTH	X=	120V	208V	240V	277V	480V	347V
<b>-C4HLPX-15A</b>	4'	1	2	3	4	5	C
<b>-C6HLPX-15A</b>	6'	1	2	3	4	5	C
<b>-C8HLPX-15A</b>	8'	1	2	3	4	5	C
<b>-C10HLPX-15A</b>	10'	1	2	3	4	5	C
<b>-C12HLPX-15A</b>	12'	1	2	3	4	5	C

<b>-C4HLP1-15A</b>	4' Cord, Hook/Loop & 15A 120V Plug w/ Quick-On® Hanger - SO cord w/ plug wired thru hook
<b>-C6HLP1-15A</b>	6' Cord, Hook/Loop & 15A 120V Plug w/ Quick-On® Hanger - SO cord w/ plug wired thru hook
<b>-C8HLP1-15A</b>	8' Cord, Hook/Loop & 15A 120V Plug w/ Quick-On® Hanger - SO cord w/ plug wired thru hook
<b>-C10HLP1-15A</b>	10' Cord, Hook/Loop & 15A 120V Plug w/ Quick-On® Hanger - SO cord w/ plug wired thru hook
<b>-C12HLP1-15A</b>	12' Cord, Hook/Loop & 15A 120V Plug w/ Quick-On® Hanger - SO cord w/ plug wired thru hook
<b>-C4HLP4-15A</b>	4' Cord, Hook/Loop & 15A 277V Plug w/ Quick-On® Hanger - SO cord w/ plug wired thru hook
<b>-C6HLP4-15A</b>	6' Cord, Hook/Loop & 15A 277V Plug w/ Quick-On® Hanger - SO cord w/ plug wired thru hook
<b>-C8HLP4-15A</b>	8' Cord, Hook/Loop & 15A 277V Plug w/ Quick-On® Hanger - SO cord w/ plug wired thru hook
<b>-C10HLP4-15A</b>	10' Cord, Hook/Loop & 15A 277V Plug w/ Quick-On® Hanger - SO cord w/ plug wired thru hook
<b>-C12HLP4-15A</b>	12' Cord, Hook/Loop & 15A 277V Plug w/ Quick-On® Hanger - SO cord w/ plug wired thru hook

CORD, HOOK/LOOP & 20A PLUG W/ SLICK-ON® HANGER -  
SO CORD W/ PLUG WIRED THRU HOOK

LENGTH	X=	120V	208V	240V	277V	480V	347V
<b>-C4HLPSO (X)</b>	4'	1	2	3	4	5	C
<b>-C6HLPSO (X)</b>	6'	1	2	3	4	5	C
<b>-C8HLPSO (X)</b>	8'	1	2	3	4	5	C
<b>-C10HLPSO (X)</b>	10'	1	2	3	4	5	C
<b>-C12HLPSO (X)</b>	12'	1	2	3	4	5	C

Suffix	Description
<b>-C4HLPSO1-15A</b>	4' Cord, Hook/Loop & 15A 120V Plug w/ Slick-On® Hanger - SO cord w/ plug wired thru hook
<b>-C6HLPSO1-15A</b>	6' Cord, Hook/Loop & 15A 120V Plug w/ Slick-On® Hanger - SO cord w/ plug wired thru hook
<b>-C8HLPSO1-15A</b>	8' Cord, Hook/Loop & 15A 120V Plug w/ Slick-On® Hanger - SO cord w/ plug wired thru hook
<b>-C10HLPSO1-15A</b>	10' Cord, Hook/Loop & 15A 120V Plug w/ Slick-On® Hanger - SO cord w/ plug wired thru hook
<b>-C12HLPSO1-15A</b>	12' Cord, Hook/Loop & 15A 120V Plug w/ Slick-On® Hanger - SO cord w/ plug wired thru hook
<b>-C4HLPSO4-15A</b>	4' Cord, Hook/Loop & 15A 277V Plug w/ Slick-On® Hanger - SO cord w/ plug wired thru hook
<b>-C6HLPSO4-15A</b>	6' Cord, Hook/Loop & 15A 277V Plug w/ Slick-On® Hanger - SO cord w/ plug wired thru hook
<b>-C8HLPSO4-15A</b>	8' Cord, Hook/Loop & 15A 277V Plug w/ Slick-On® Hanger - SO cord w/ plug wired thru hook
<b>-C10HLPSO4-15A</b>	10' Cord, Hook/Loop & 15A 277V Plug w/ Slick-On® Hanger - SO cord w/ plug wired thru hook
<b>-C12HLPSO4-15A</b>	12' Cord, Hook/Loop & 15A 277V Plug w/ Slick-On® Hanger - SO cord w/ plug wired thru hook

CORD, HOOK/LOOP & 20A PLUG W/ SLICK-ON® HANGER -  
SINGLE FUSE (incl.) SO CORD W/ PLUG WIRED THRU HOOK

LENGTH	X3=	120V	277V	347V
<b>-C4HLPSOF (X3)</b>	4'	1	4	C
<b>-C6HLPSOF (X3)</b>	6'	1	4	C
<b>-C8HLPSOF (X3)</b>	8'	1	4	C
<b>-C10HLPSOF (X3)</b>	10'	1	4	C
<b>-C12HLPSOF (X3)</b>	12'	1	4	C

CORD, HOOK/LOOP & 20A PLUG W/ SLICK-ON® HANGER -  
DOUBLE FUSE (incl.) SO CORD W/ PLUG WIRED THRU HOOK

LENGTH	X4=	208V	240V	480V
<b>-C4HLPSOFF (X4)</b>	4'	2	3	5
<b>-C6HLPSOFF (X4)</b>	6'	2	3	5
<b>-C8HLPSOFF (X4)</b>	8'	2	3	5
<b>-C10HLPSOFF (X4)</b>	10'	2	3	5
<b>-C12HLPSOFF (X4)</b>	12'	2	3	5

<b>-C4HLSO</b>	4' Cord & Hook/Loop w/ Slick-On® Hanger - SO cord wired thru hook
<b>-C6HLSO</b>	6' Cord & Hook/Loop w/ Slick-On® Hanger - SO cord wired thru hook
<b>-C8HLSO</b>	8' Cord & Hook/Loop w/ Slick-On® Hanger - SO cord wired thru hook
<b>-C10HLSO</b>	10' Cord & Hook/Loop w/ Slick-On® Hanger - SO cord wired thru hook
<b>-C12HLSO</b>	12' Cord & Hook/Loop w/ Slick-On® Hanger - SO cord wired thru hook

Suffix	Description																														
	CORD, HOOK/LOOP W/ SLICK-ON® HANGER - SINGLE FUSE (incl.) SO CORD W/ PLUG WIRED THRU HOOK																														
	<table border="1"> <thead> <tr> <th>LENGTH</th> <th>X2=</th> <th>120V</th> <th>277V</th> <th>347V</th> </tr> </thead> <tbody> <tr> <td><b>-C4HLSOF (X2)</b></td> <td>4'</td> <td><b>1</b></td> <td><b>4</b></td> <td><b>C</b></td> </tr> <tr> <td><b>-C6HLSOF (X2)</b></td> <td>6'</td> <td><b>1</b></td> <td><b>4</b></td> <td><b>C</b></td> </tr> <tr> <td><b>-C8HLSOF (X2)</b></td> <td>8'</td> <td><b>1</b></td> <td><b>4</b></td> <td><b>C</b></td> </tr> <tr> <td><b>-C10HLSOF (X2)</b></td> <td>10'</td> <td><b>1</b></td> <td><b>4</b></td> <td><b>C</b></td> </tr> <tr> <td><b>-C12HLSOF (X2)</b></td> <td>12'</td> <td><b>1</b></td> <td><b>4</b></td> <td><b>C</b></td> </tr> </tbody> </table>	LENGTH	X2=	120V	277V	347V	<b>-C4HLSOF (X2)</b>	4'	<b>1</b>	<b>4</b>	<b>C</b>	<b>-C6HLSOF (X2)</b>	6'	<b>1</b>	<b>4</b>	<b>C</b>	<b>-C8HLSOF (X2)</b>	8'	<b>1</b>	<b>4</b>	<b>C</b>	<b>-C10HLSOF (X2)</b>	10'	<b>1</b>	<b>4</b>	<b>C</b>	<b>-C12HLSOF (X2)</b>	12'	<b>1</b>	<b>4</b>	<b>C</b>
LENGTH	X2=	120V	277V	347V																											
<b>-C4HLSOF (X2)</b>	4'	<b>1</b>	<b>4</b>	<b>C</b>																											
<b>-C6HLSOF (X2)</b>	6'	<b>1</b>	<b>4</b>	<b>C</b>																											
<b>-C8HLSOF (X2)</b>	8'	<b>1</b>	<b>4</b>	<b>C</b>																											
<b>-C10HLSOF (X2)</b>	10'	<b>1</b>	<b>4</b>	<b>C</b>																											
<b>-C12HLSOF (X2)</b>	12'	<b>1</b>	<b>4</b>	<b>C</b>																											
	CORD, HOOK/LOOP W/ SLICK-ON® HANGER - DOUBLE FUSE (incl.) SO CORD W/ PLUG WIRED THRU HOOK																														
	<table border="1"> <thead> <tr> <th>LENGTH</th> <th>X3=</th> <th>208V</th> <th>240V</th> <th>480V</th> </tr> </thead> <tbody> <tr> <td><b>-C4HLSOFF (X3)</b></td> <td>4'</td> <td><b>2</b></td> <td><b>3</b></td> <td><b>5</b></td> </tr> <tr> <td><b>-C6HLSOFF (X3)</b></td> <td>6'</td> <td><b>2</b></td> <td><b>3</b></td> <td><b>5</b></td> </tr> <tr> <td><b>-C8HLSOFF (X3)</b></td> <td>8'</td> <td><b>2</b></td> <td><b>3</b></td> <td><b>5</b></td> </tr> <tr> <td><b>-C10HLSOFF (X3)</b></td> <td>10'</td> <td><b>2</b></td> <td><b>3</b></td> <td><b>5</b></td> </tr> <tr> <td><b>-C12HLSOFF (X3)</b></td> <td>12'</td> <td><b>2</b></td> <td><b>3</b></td> <td><b>5</b></td> </tr> </tbody> </table>	LENGTH	X3=	208V	240V	480V	<b>-C4HLSOFF (X3)</b>	4'	<b>2</b>	<b>3</b>	<b>5</b>	<b>-C6HLSOFF (X3)</b>	6'	<b>2</b>	<b>3</b>	<b>5</b>	<b>-C8HLSOFF (X3)</b>	8'	<b>2</b>	<b>3</b>	<b>5</b>	<b>-C10HLSOFF (X3)</b>	10'	<b>2</b>	<b>3</b>	<b>5</b>	<b>-C12HLSOFF (X3)</b>	12'	<b>2</b>	<b>3</b>	<b>5</b>
LENGTH	X3=	208V	240V	480V																											
<b>-C4HLSOFF (X3)</b>	4'	<b>2</b>	<b>3</b>	<b>5</b>																											
<b>-C6HLSOFF (X3)</b>	6'	<b>2</b>	<b>3</b>	<b>5</b>																											
<b>-C8HLSOFF (X3)</b>	8'	<b>2</b>	<b>3</b>	<b>5</b>																											
<b>-C10HLSOFF (X3)</b>	10'	<b>2</b>	<b>3</b>	<b>5</b>																											
<b>-C12HLSOFF (X3)</b>	12'	<b>2</b>	<b>3</b>	<b>5</b>																											
<b>-GR</b>	Gray Lektrocote® Finish on housing; replace <b>-WH</b> in catalog number																														
<b>-LRI'</b>	Lower Luminaire Retainer - a snap-in cable on housing secures reflector to ballast housing																														
<b>-P</b>	High Strength Polycarbonate Refractor																														
<b>-QSS</b>	Quartz Standby System - ON when power is restored, OFF when HID lamp restrikes. Wattage of quartz lamp (included) limited to 250w max for 750w and higher HID fixtures and 150w max for lower wattage HID fixtures. Uses 120V DC bayonet base lamp. Factory wired.																														
<b>-QST</b>	Quartz Standby with Time Delay - ON when power is restored, OFF when HID lamp restrikes and is warmed up. Wattage not to exceed wattage of HID lamp (250W max. recommended). Uses 120V DC bayonet base lamp. Factory wired.																														
<b>-SO</b>	Slick-On® Thru Wire Outlet Box for 3/4" pendant or 1/2" or 3/4" side entry conduit																														

Suffix	Description								
	SLICK-ON® THRU WIRE OUTLET BOX, SINGLE FUSE (incl.) for 3/4" pendant or side entry conduit								
	<table border="1"> <thead> <tr> <th>X3=</th> <th>120V</th> <th>277V</th> <th>347V</th> </tr> </thead> <tbody> <tr> <td><b>-SOF (X3)</b></td> <td><b>1</b></td> <td><b>4</b></td> <td><b>F</b></td> </tr> </tbody> </table>	X3=	120V	277V	347V	<b>-SOF (X3)</b>	<b>1</b>	<b>4</b>	<b>F</b>
X3=	120V	277V	347V						
<b>-SOF (X3)</b>	<b>1</b>	<b>4</b>	<b>F</b>						
	SLICK-ON® THRU WIRE OUTLET BOX, DOUBLE FUSE (incl.) for 3/4" pendant or side entry conduit (not for Canada)								
	<table border="1"> <thead> <tr> <th>X4=</th> <th>208V</th> <th>240V</th> <th>480V</th> </tr> </thead> <tbody> <tr> <td><b>-SOFF (X4)</b></td> <td><b>2</b></td> <td><b>3</b></td> <td><b>5</b></td> </tr> </tbody> </table>	X4=	208V	240V	480V	<b>-SOFF (X4)</b>	<b>2</b>	<b>3</b>	<b>5</b>
X4=	208V	240V	480V						
<b>-SOFF (X4)</b>	<b>2</b>	<b>3</b>	<b>5</b>						
<b>-TRI(X)</b>	Top Luminaire Retainer - chain secures ballast housing to structure when additional safety precautions are required. Shipped in housing carton. Specify length (X), recommended maximum slack is 3"								

1 Luminaire retainers/safety cables reduce risk of equipment falling

NOTE: For specific applications, bottom enclosures may be required. For more information, please see specific lamp manufacturers' data and the NEMA white paper "Best Practices for Metal Halide Lighting Systems" posted on the NEMA web site ([www.nema.org](http://www.nema.org)).

WARNING: Improper selection, installation, operation, servicing, removal, and disposal of lighting products may create serious hazardous including fires, explosions, shock, burns, cuts, impaired vision, falling objects, and environmental contamination. Reduce risks by using the guidance of licensed professionals throughout the product life cycle, and following individual product, component, and accessory safety instructions and labels.

We offer this in the interest of safety for our customers, who may not be aware of the potentially high risk involved in the misuse of these products.

## ORDERING INFORMATION

### ACCESSORIES

(order separately)

Catalog #	Description
<b>B-LLR<sup>1</sup></b>	Lower Luminaire Retainer - 2' cable secures reflector to ballast housing
<b>B-TLR(6)<sup>1</sup></b>	6' Top Luminaire Retainer - chain secures ballast housing to structure when additional safety precautions are required
<b>B-TLR(10)<sup>1</sup></b>	10' Top Luminaire Retainer - chain secures ballast housing to structure when additional safety precautions are required
<b>B-TLR(12)<sup>1</sup></b>	12' Top Luminaire Retainer - chain secures ballast housing to structure when additional safety precautions are required
<b>B-TLR(16)<sup>1</sup></b>	16' Top Luminaire Retainer - chain secures ballast housing to structure when additional safety precautions are required
<b>BL-LR-14<sup>2</sup></b>	Tempered Glass Lens - thermal shock & impact resistant; gasketed on corrosion-resistant steel lens ring (not dust tight) required for 175, 250, 320, 350 & 400 watt metal halide luminaires; for BI and BC reflector only
<b>BL-QO</b>	Quick-On 3/4" pendant mount
<b>BL-SO</b>	Slick-On Thru Wire Outlet Box for 3/4" pendant or 3/4, 1/2 side entry conduit
<b>BL-SOF</b>	Slick-On Single Fusing (fuse not incl.) thru wire outlet box for 3/4" pendant or 3/4, 1/2 side entry conduit mount with single fuse holder
<b>BL-SOFF</b>	Slick-On Double Fusing (fuses not incl.) thru wire outlet box for 3/4" pendant or 3/4, 1/2 side entry conduit mount with double fuse holder (not for Canada)
<b>WG-14</b>	14" Wireguard - corrosion resistant, welded steel w/ center lamp access

1 Luminaire retainers/safety cables reduce risk of equipment falling.

2 Bottom enclosures are required unless lamps designated as "suitable for open use" are used.

### MOUNTING ACCESSORIES

(order separately)

PLUGS ARE TWIST-LOCK® TYPE AS MANUFACTURED BY HUBBELL WIRING DEVICES.

Catalog #	Description
<b>BLA-C4HLP-1</b>	4' Cord, Hook/Loop and 120V 20A Twist-Lock® Plug
<b>BLA-C4HLP-4</b>	4' Cord, Hook/Loop and 277V 20A Twist-Lock® Plug
<b>BLA-C4HLP1-15A</b>	4' Cord, Hook/Loop and 120V 15A Twist-Lock® Plug
<b>BLA-C4HLP4-15A</b>	4' Cord, Hook/Loop and 277V 15A Twist-Lock® Plug
<b>HOOK/LOOP<sup>1</sup></b>	Hook - cast aluminum 3/4" NPS male; includes safety screw; converts to Loop with strap included
<b>H3/4AL3/4<sup>1</sup></b>	Swivel Aligner - complete with box for thru wiring; all hubs tapped for 3/4" conduit - 25° swivel

1 CSA certified.

2 Cord, Hook/Loop and Plug must be added to fixture as option, example: **-C2HLP4**.

3 Cord, Hook/Loop and Dead Front Plug must be added to fixture as option, example: **-DFP4**.

NOTE: Cord used with above accessories is 16/3 SOWA 105°C NEMA configurations.

Due to our continued efforts to improve our products, product specifications are subject to change without notice.



Hubbell Industrial Lighting • 701 Millennium Boulevard • Greenville, SC 29607 • PHONE: 864-678-1000

For more information visit our web site: [www.hubbell-itg.com](http://www.hubbell-itg.com)