

# Copper Compression Sleeves

## Long Barrel

### Conductor Range: 1000kcmil-#6



**A**

## TYPE CTL

### Features

- Manufactured from high strength seamless copper tubing
- Electro-Tin plated
- Chamfered entry
- Color coded
- Suitable for use in circuits rated 35KV or less, proper high voltage spacing and insulation techniques must be used
- UL Listed and CSA Certified with ILSCO and major competitor's compression tools
- UL467 Listed 500 kcmil - 8 AWG , #8 - #2 SOL
- Rated to 90° C

### Benefits

- Offers maximum conductivity and excellent crimping characteristics
- Provides low contact resistance
- For easy conductor insertion
- Identifies the proper compression die
- Application versatility
- Reduces inventory requirements
- For grounding and bonding applications

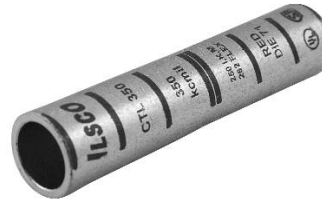
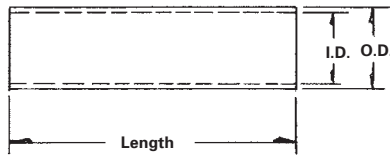

Catalog Number	Wire Size	Alt Wire Size	Expanded* Wire Range	Barrel Length	Die Color Code	Die Index	Die Catalog Number	O.D.	I.D.
CTL-8	8 AWG	#8 Flex, #8 Sol	-	1.75	Red	I-21	ILD-21	0.272	0.179
CTL-6	6 AWG	#6 Flex, #6 Sol	-	2.375	Blue	I-24	ILD-24	0.320	0.225
CTL-4	4 AWG	#4 Sol	4-6 AWG	2.375	Gray	I-29	ILD-29	0.343	0.250
CTL-3	3 AWG	#4 Flex	3-6 AWG	2.375	White	I-29	ILD-29	0.375	0.275
CTL-2	2 AWG	#2 Sol	2-6 AWG	2.625	Brown	I-33	ILD-33	0.421	0.312
CTL-1	1 AWG	#2 Flex	1-6 AWG	2.875	Green	I-37	ILD-37	0.468	0.359
CTL-1/0	1/0 AWG	#1 Flex	1/0-6 AWG	2.875	Pink	I-42	ILD-42	0.515	0.390
CTL-2/0	2/0 AWG	1/0 Flex	2/0-4 AWG	3.125	Black	I-45	ILD-45	0.562	0.437
CTL-3/0	3/0 AWG	2/0 Flex	3/0-2 AWG	3.125	Orange	I-50	ILD-50	0.609	0.484
CTL-4/0	4/0 AWG	3/0 Flex	4/0-1 AWG	3.375	Purple	I-54	ILD-54	0.687	0.546
CTL-250	250kcmil	4/0 Flex	250kcmil-1/0 AWG	3.375	Yellow	I-62	ILD-62	0.750	0.593
CTL-300	300kcmil	250 G,H Flex	300kcmil-2/0 AWG	4.125	White	I-66	ILD-66	0.812	0.660
CTL-350	350kcmil	250 I,K,M Flex 262.2 DLO	350kcmil-3/0 AWG	4.125	Red	I-71	ILD-71	0.890	0.703
CTL-400	400kcmil	300 G,H,I,K,M Flex 313.1 DLO	400kcmil-4/0 AWG	4.375	Blue	I-76	ILD-76	0.937	0.750
CTL-500	500kcmil	350 G,H,I,K,M Flex 373.7 DLO	500kcmil-250kcmil	4.625	Brown	I-87	ILD-87	1.062	0.828
CTL-600	600kcmil	400 G,H,I,K,M Flex 444.4 DLO	600kcmil-250kcmil	4.625	Green	I-94	ILD-94	1.187	0.920
CTL-650	650kcmil	500 G,H,I,K,M Flex 535.3 DLO	650kcmil-350kcmil	4.625	Pink	I-99	ILD-99	1.222	0.962
CTL-700	700kcmil	500 G,H,I,K,M Flex 535.3 DLO	700kcmil-350kcmil	5.875	Pink	I-99	ILD-99	1.250	0.991
CTL-750	750kcmil	600 G,H,I,K,M Flex 646.4 DLO	750kcmil-500kcmil	5.875	Black	I-106	ILD-106	1.313	1.031
CTL-1000	1000kcmil	750 G,H,I Flex 777.7 DLO	1000kcmil-750kcmil	6.125	White	I-125	ILD-125	1.500	1.172

All wire sizes, unless noted otherwise, are American Wire Gauge (AWG)

\* When installed with specified dieless tools

See pages 98 to 103 for complete tooling information.

UL File E6207