

Zinc Insulated Grounding Bushings

For Threaded Rigid Conduit and IMC

Application:

Used with a locknut to terminate threaded rigid and IMC conduit to a box or enclosure and to provide a smooth pulling surface. Thermoplastic liner prevents damage to wire insulation. Liner rated at 150°C.

Features:

- The plastic liner won't chip, crack, swell or shrink. It resists corrosion, chemicals, and temperature extremes.
- Set-screw provided with each fitting locks bushing in any desired position.
- UL Listed for use with Copper or Aluminum Grounding Conductors.

Standard Materials:

Zinc Die Cast/Open side tin plated aluminum lug.



UL Listed:
E88878



Type 25BIZ4L

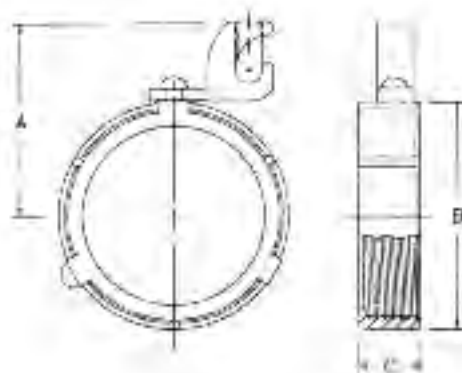

| CATALOG NUMBER | TRADE SIZE | GROUNDING LUG CAP. MIN. - MAX. SOLID STRAND | DIM A | DIM B | DIM C | UNIT PACK | STANDARD PACK | WEIGHT (LBS.) PER 100 PCS. | NAED MFG #78-5994 UPC/DCI # |
|----------------|------------|---|-------|-------|-------|-----------|---------------|----------------------------|-----------------------------|
| 20BIZ4L | 1/2" | #14 - #4 | 1.313 | 1.063 | 0.500 | 100 | 1000 | 4 | 20009 |
| 21BIZ4L | 3/4" | #14 - #4 | 1.406 | 1.281 | 0.500 | 50 | 500 | 6 | 20016 |
| 22BIZ4L | 1" | #14 - #4 | 1.563 | 1.531 | 0.596 | 25 | 250 | 8 | 20022 |
| 23BIZ4L | 1-1/4" | #14 - #4 | 1.750 | 1.875 | 0.625 | 25 | 250 | 14 | 20028 |
| 24BIZ4L | 1-1/2" | #14 - #4 | 2.031 | 2.156 | 0.625 | 25 | 250 | 16 | 20038 |
| 25BIZ4L | 2" | #14 - #4 | 2.281 | 2.625 | 0.625 | 25 | 250 | 23 | 25007 |
| 25BIZ0L | 2" | #14 - #1/0 | 2.500 | 2.625 | 0.625 | 25 | 250 | 26 | 25008 |
| 26BIZ0L | 2-1/2" | #14 - #1/0 | 2.875 | 3.219 | 0.875 | - | 10 | 39 | 25023 |
| 26BIZ40L | 2-1/2" | #6 - #250MCM | 3.156 | 3.219 | 0.875 | - | 10 | 43 | 25024 |
| 27BIZ0L | 3" | #14 - #1/0 | 3.313 | 3.813 | 0.875 | - | 10 | 46 | 25035 |
| 27BIZ40L | 3" | #6 - #250MCM | 3.625 | 3.813 | 0.875 | - | 10 | 51 | 25036 |
| 28BIZ0L | 3-1/2" | #14 - #1/0 | 3.718 | 4.344 | 0.875 | - | 10 | 50 | 28049 |
| 28BIZ40L | 3-1/2" | #6 - #250MCM | 3.875 | 4.344 | 0.875 | - | 10 | 56 | 28050 |
| 29BIZ0L | 4" | #14 - #1/0 | 3.968 | 4.813 | 0.875 | - | 10 | 58 | 28061 |
| 29BIZ40L | 4" | #6 - #250MCM | 4.125 | 4.813 | 0.875 | - | 10 | 65 | 28062 |