

Wire Termination

Non-Insulated Ring Terminals

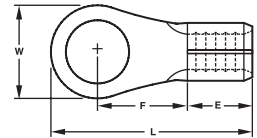

Wire Range (AWG)	Wire Range (mm ²)	Stud Size (Inches)	Stud Size (mm)	Dimensions (Inches)*				Dimensions (mm)**				Ctn. Qty.	Cat. No.	Ctn. Qty.	Cat. No.
				L	W	E	F	L	W	E	F				
22 - 18	0.5 - 1.0	8	4.3	.622	.315	.189	.276	15.8	8.0	4.8	7.0	25	83-0131	—	—
		10	5.3	.622	.315	.189	.276	15.8	8.0	4.8	7.0	25	83-0141	—	—
16 - 14	1.5 - 2.5	6	3.7	.567	.260	.189	.248	14.4	6.6	4.8	6.3	25	83-0221	—	—
		8	4.3	.661	.335	.189	.307	16.8	8.5	4.8	7.8	25	83-0231	—	—
		10	5.3	.661	.374	.189	.287	16.8	9.5	4.8	7.3	25	83-0241	1,000	84-0241
12 - 10	4.0 - 6.0	8	4.3	.772	.374	.236	.358	19.6	9.5	6.0	9.1	25	83-0331	—	—
		10	5.3	.772	.374	.236	.358	19.6	9.5	6.0	9.1	25	83-0341	1,000	84-0341
		1/4	6.4	.886	.472	.236	.413	22.5	12.0	6.0	10.5	25	83-0351	—	—
8	8.0	10	5.3	.937	.472	.337	.366	23.8	12.0	8.5	9.3	25	83-0421	—	—
		1/4	6.4	.937	.472	.337	.366	23.8	12.0	8.5	9.3	25	83-0431	—	—
		5/16	8.4	1.161	.591	.337	.543	29.8	15.0	8.5	13.8	25	83-0441	—	—
		3/8	10.5	1.161	.591	.337	.543	29.8	15.0	8.5	13.8	25	83-0451	—	—
6	14.0	10	5.3	1.173	.472	.413	.524	29.8	12.0	10.5	13.3	20	83-0511	—	—
		1/4	6.4	1.173	.472	.413	.524	29.8	12.0	10.5	13.3	20	83-0521	—	—
		5/16	8.4	1.280	.630	.413	.559	32.5	16.0	10.5	14.2	20	83-0531	—	—
		3/8	10.5	1.280	.630	.413	.559	32.5	16.0	10.5	14.2	20	83-0541	—	—
4	22.0	1/4	6.4	1.319	.650	.472	.531	33.5	16.5	12.0	13.5	20	83-0611	—	—
		5/16	8.4	1.319	.650	.472	.531	33.5	16.5	12.0	13.5	20	83-0621	—	—
		3/8	10.5	1.319	.650	.472	.531	33.5	16.5	12.0	13.5	20	83-0631	—	—

105°C/600 Volts max.

*Plus or minus .020 in.

**Plus or minus .50 in.

Listed 774A Cu Only Pressure Wire Connector

Vinyl Insulated Spade Terminals

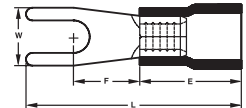

Wire Range (AWG)	Wire Range (mm ²)	Stud Size (Inches)	Stud Size (mm)	Max. Wire Ins. Dia. (Inches)	Max. Wire Ins. Dia. (mm)	Dimensions (Inches)				Dimensions (mm)				Ctn. Qty.	Cat. No.	Ctn. Qty.	Cat. No.
						L	W	E	F	L	W	E	F				
22 - 18	0.5 - 1.0	6	3.7	.157	4.0	.827	.252	.394	.256	21.0	6.4	10.0	6.5	25	83-7111	1,000	84-7111
		8	4.3			.827	.283	.394	.256	21.0	7.2	10.0	6.5	25	83-7121	—	—
		10	5.3			.827	.374	.394	.256	21.0	9.5	10.0	6.5	25	83-7131	—	—
16 - 14	1.5 - 2.5	6	3.7	.177	4.5	.827	.236	.394	.256	21.0	6.0	10.0	6.5	25	83-7151	—	—
		8	4.3			.827	.283	.394	.256	21.0	7.2	10.0	6.5	25	83-7161	1,000	84-7161
		10	5.3			.827	.366	.394	.256	21.0	9.3	10.0	6.5	25	83-7171	1,000	84-7171
12 - 10	4.0 - 6.0	6	3.7	.248	6.3	1.004	.327	.512	.276	25.5	8.3	13.0	7.0	25	83-7201	—	—
		8	4.3			1.004	.283	.512	.357	25.5	9.0	13.0	7.0	25	83-7211	—	—
		10	5.3			1.004	.283	.512	.354	25.5	9.0	13.0	7.0	25	83-7221	500	84-7221
		1/4	6.4			1.240	.472	.512	.472	31.5	12.0	13.0	12.0	25	83-7231	—	—

75° C/600 Volts max.

Listed 774A Cu Only Pressure Wire Connector

Crimp Tools



#30-518 Tool w/die
#30-519 Replacement die



#83-005



#88-843

Insulated and Non-Insulated Terminals, Splices and Disconnects (#22 - #10 AWG) are UL Listed when used with IDEAL Crimp Tool #30-518 (Replacement Die #30-519). Non-Insulated Ring Terminals (#8 - #4 AWG) are UL Listed when used with IDEAL Crimp Tool #83-005 or #88-843. Non-Insulated Disconnects, Splices and Vinyl Insulated Parallel Splices (#22 - #10 AWG) are not UL Listed; recommended IDEAL Crimp Tool #30-518. Non-Insulated Splices (#8 - #4 AWG) are not UL Listed, recommended IDEAL Crimp Tool #83-005 or #88-843.